



BAVARIA
YACHTS



Passion made

BAVARIA CRUISER-LINE

BAVARIA CRUISER 37 –
SALES MANUAL

BAVARIA CRUISER 37 SALESMANUAL

1 CRUISER 37

1.1 Story	3
1.2 Ten Reasons to Buy	4

2 EXTERIOR

2.1 General Dimensions	6
2.2 Hull	9
2.3 Keel	10
2.4 Deck	14
2.5 Cockpit	16
2.6 Rigg / Sailplan	22
2.7 Standing & Running Gear	26
2.8 Mainsheet	33

3 INTERIOR

3.1 Interior Layout	36
3.2 Standing Heights	39
3.4 Layout B	40
3.5 Layout C	41
3.6 Layout D	45

4 SYSTEMS

4.1 Steering System	48
4.2 Electrical System	50
4.3 Navigation Equipment	52
4.4 Entertainment System	53
4.5 Equipment Water	54
4.6 Equipment Heating	55
4.7 Propulsion	57

1.1 STORY

BAVARIA CRUISER 37...

With the BAVARIA CRUISER 37 we have succeeded in bringing together the most important aspects of sailing – sailing pleasure and spaciousness – in one boat. This yacht has excellent – and very safe – sailing characteristics. The XXL cockpit area is pleasantly commodious during sailing and in between. And below deck there is all the room you need for six people. It comes in a 2- and a 3-cabin version. The BAVARIA CRUISER 37 is available in two different deck layouts.



1.2 TEN REASONS TO BUY

BAVARIA CRUISER 37...

- BAVARIA CRUISER Line by BAVARIA YACHTS and Farr Yacht Design
- Significant and classic line for big space in cockpit and as well as in the interior
- Space for 6 max 8 crew members below deck
- Layouts with 2- and 3-cabins
- Standing height in the salon, approx. 1,95m
- Big triangular master bed in forward cabin (1.90x2.00m)
- Wide and rectangular double beds in aft cabins with a length of 2,05m
- Separate L-Pantry for storage, cooling (90 l) and cooking (2 burner gas stove)
- 9/10 anodized aluminium rig with 2 sets of aft swept spreaders (25°) and optional furling rig
- Available with two helmstands

2.0 Exterior

2 EXTERIOR

[2.1 General Dimensions](#)

[2.2 Hull](#)

[2.3 Keel](#)

[2.4 Deck](#)

[2.5 Cockpit](#)

[2.6 Rigg / Sailplan](#)

[2.7 Standing & Running Gear](#)

[2.8 Mainsheet](#)



Please see actual pricelist for details Standard and Option

2.1 Main Characteristics

LOA	11,30 m	37' 07" ft
LOA [incl. Bowsprit]	11,81 m	38' 75" ft
Hull Length	10.90 m	35' 76" ft
LWL	10.20 m	33' 46" ft
Beam max.	3.70 m	12' 1" ft
Standard Keel Draft	2.02 m	6' 63" ft
Shallow Keel Draft	1.71 m	5' 61" ft
Ballast [standard]	2084 kg	4.594 lb
Ballast [shallow draft]	2293 kg	5.055 lb
Displacement [standard]	7450 kg	16.424 lb
Displacement [shallow draft]	7778 kg	17.148 lb
Engine [standard]	20.9 kW [28 mhp]	
Engine [optional]	-	
Fuel Tank [approx.]	150 L	40 gal
Water Tank [approx.]	350 L	92 gal
Sail Area	67.40 m ²	725 sq.ft
Mainsail [standard]	40.70 m ²	438 sq.ft
Mainsail [furling]	34.00 m ²	366 sq.ft
Jib [selftacking]	-	-
Genoa [106 %]	26.70 m ²	287 sq.ft
Gennaker	81.80 m ²	880 sq.ft
Code 0	-	-
Mast height above WL	17.20 m	56' 43" ft
I	14.06 m	46' 13" ft
J	3.73 m	12' 24" ft
P	13.58 m	44' 55" ft
E	5.10 m	16' 73" ft
CE category	A8 / B12	
Design	FARR Yacht Design	

Please see actual pricelist for details Standard and Option

2.1 Dimensions Hull



Please see actual pricelist for details Standard and Option

2.1 Dimensions Deck

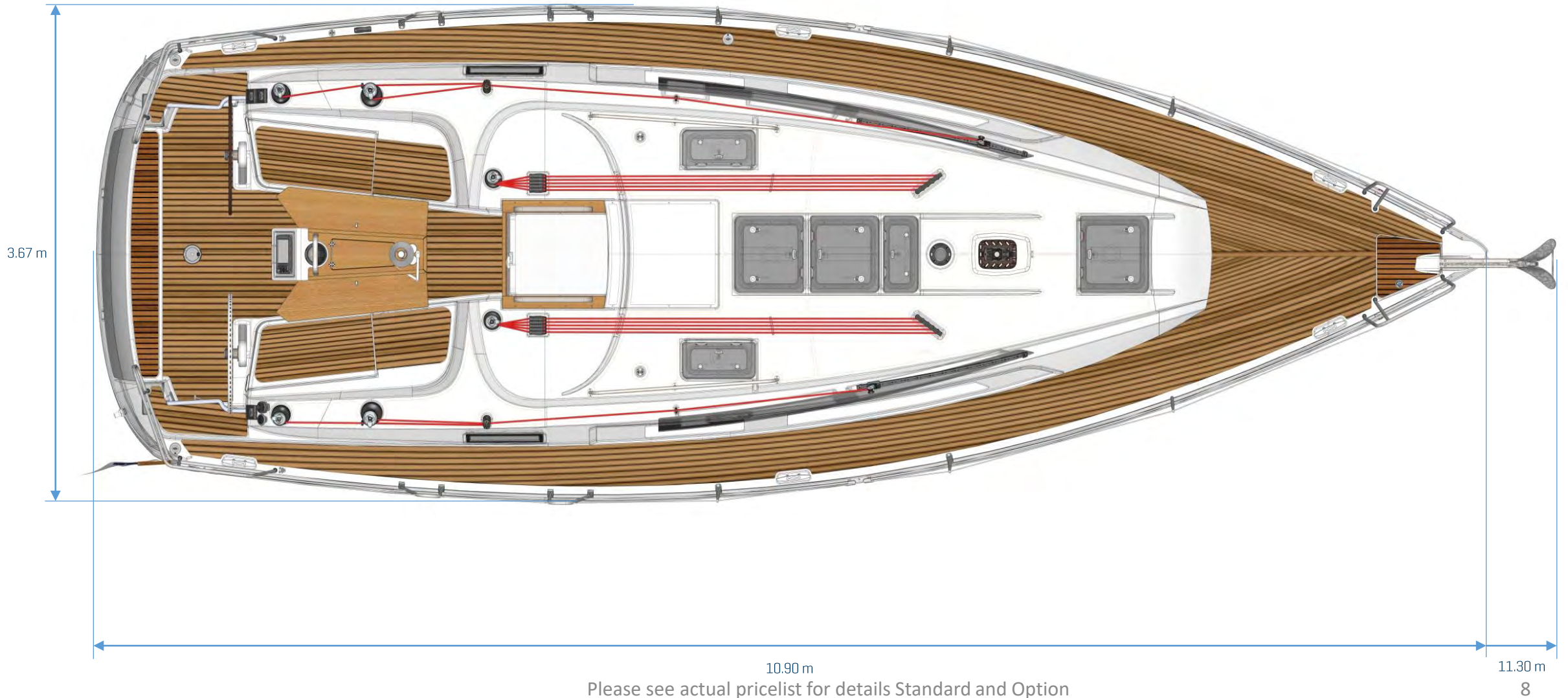

Please see actual pricelist for details Standard and Option

2.2 Hull

Hull

- Hull produced in hand lay-up in E-glass with polyester resin and PVC foam core above waterline
- Hull ISO NPG gelcoat
- Cove- and waterline in ISO NPG gelcoat
- GRP innerliner in hand lay-up in E-glass with polyester resin
- Including drainage groves for bilge, passage for tubes, hoses and wiring and reinforcements and bulkheads for water protection and loads

Shroud & Chainplates

- Reinforcements in way of shroud chainplates and in forward and aft compartment

Hull Windows

- hull windows in mineral glass glued to recessed hull with print and plastic frame from inside

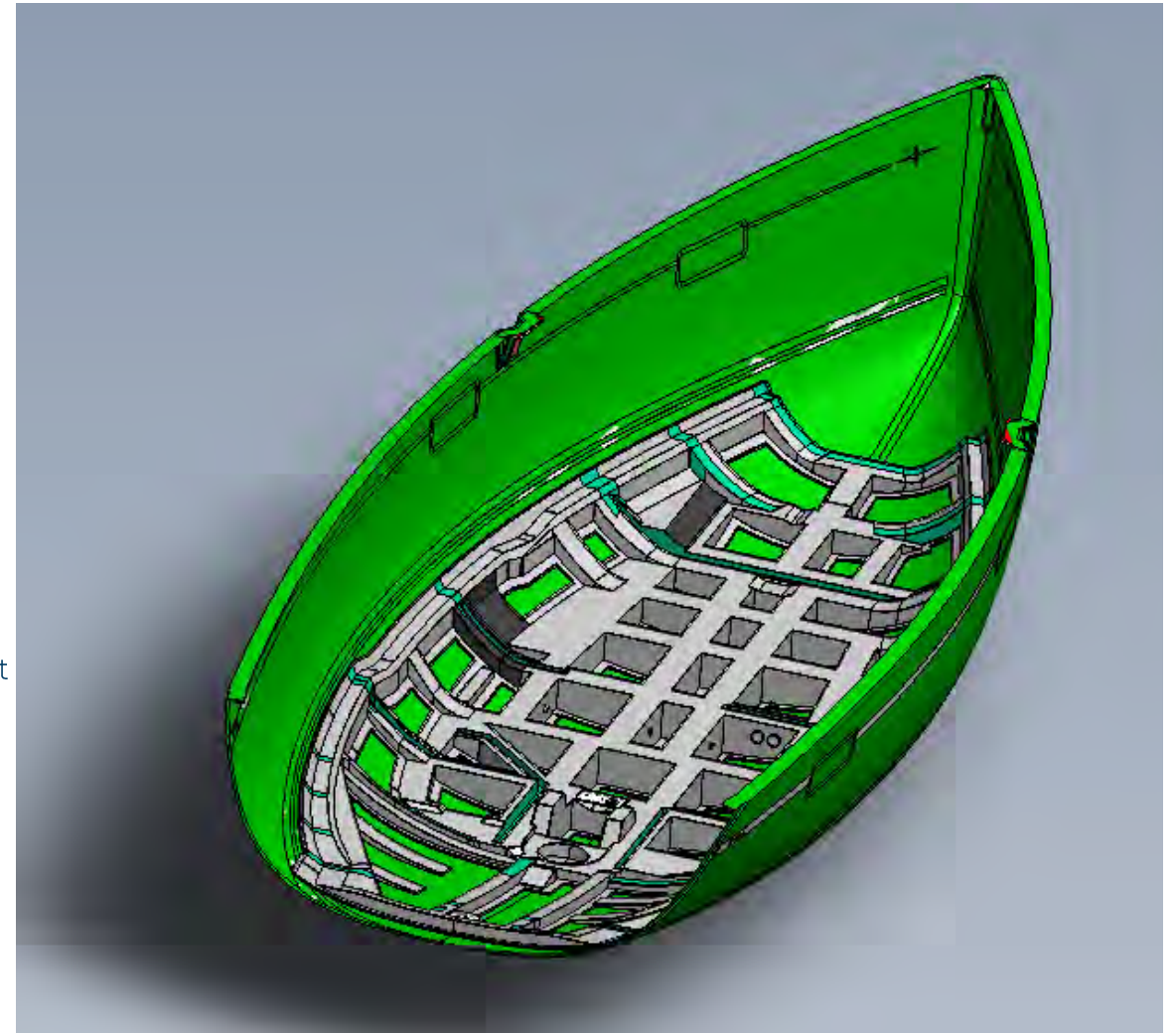

2.3 Keel

- L-shaped keel, cast iron, draft 2.02 m
- Keel in cast iron connected with keel bolts and glued to hull and hull structures
- Keel divided in 2 parts [for oversea transport purposes] – screws and glue for connection
- Draft: 2.02 m – Ballast: 2084 kg

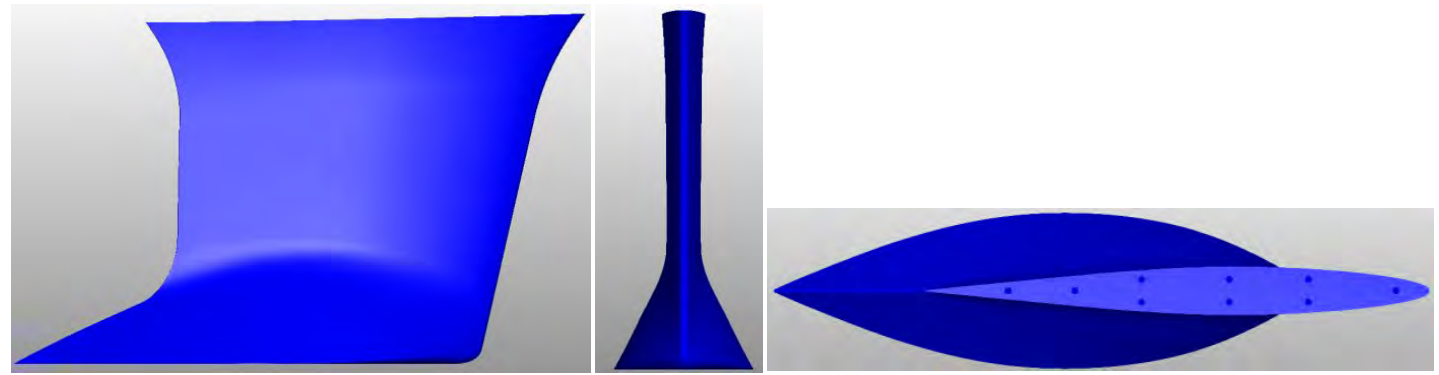

Please see actual pricelist for details Standard and Option

2.3 Keel

- L-shaped keel, cast iron, draft 1.95 m

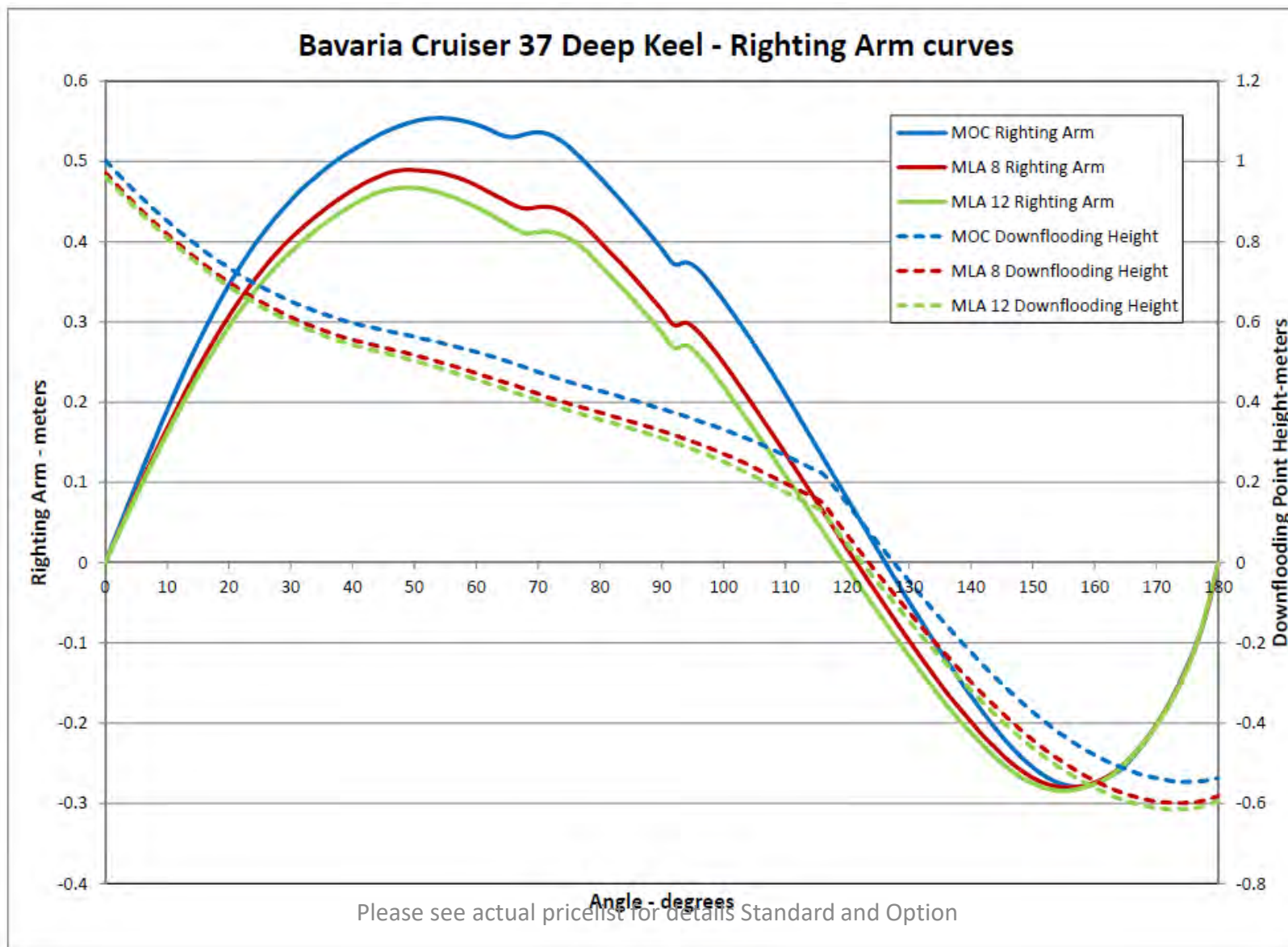

2.3 Keel

L-shaped keel, cast iron, draft 1.71 m

- Keel in cast iron connected with keel bolts and glued to hull and hull structures
- Draft: 1.71 m – Ballast: 2293 kg

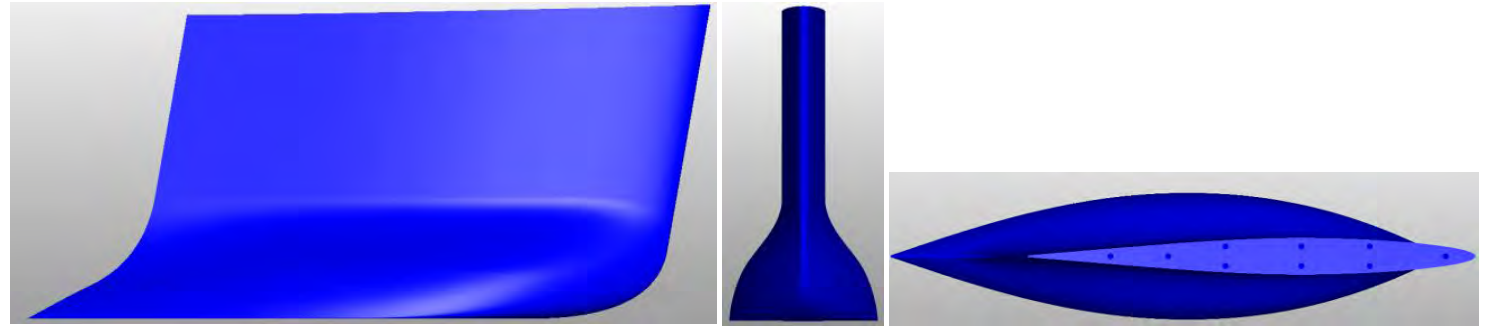

Please see actual pricelist for details Standard and Option

2.3 Keel

- L-shaped keel, cast iron, draft 1.63 m

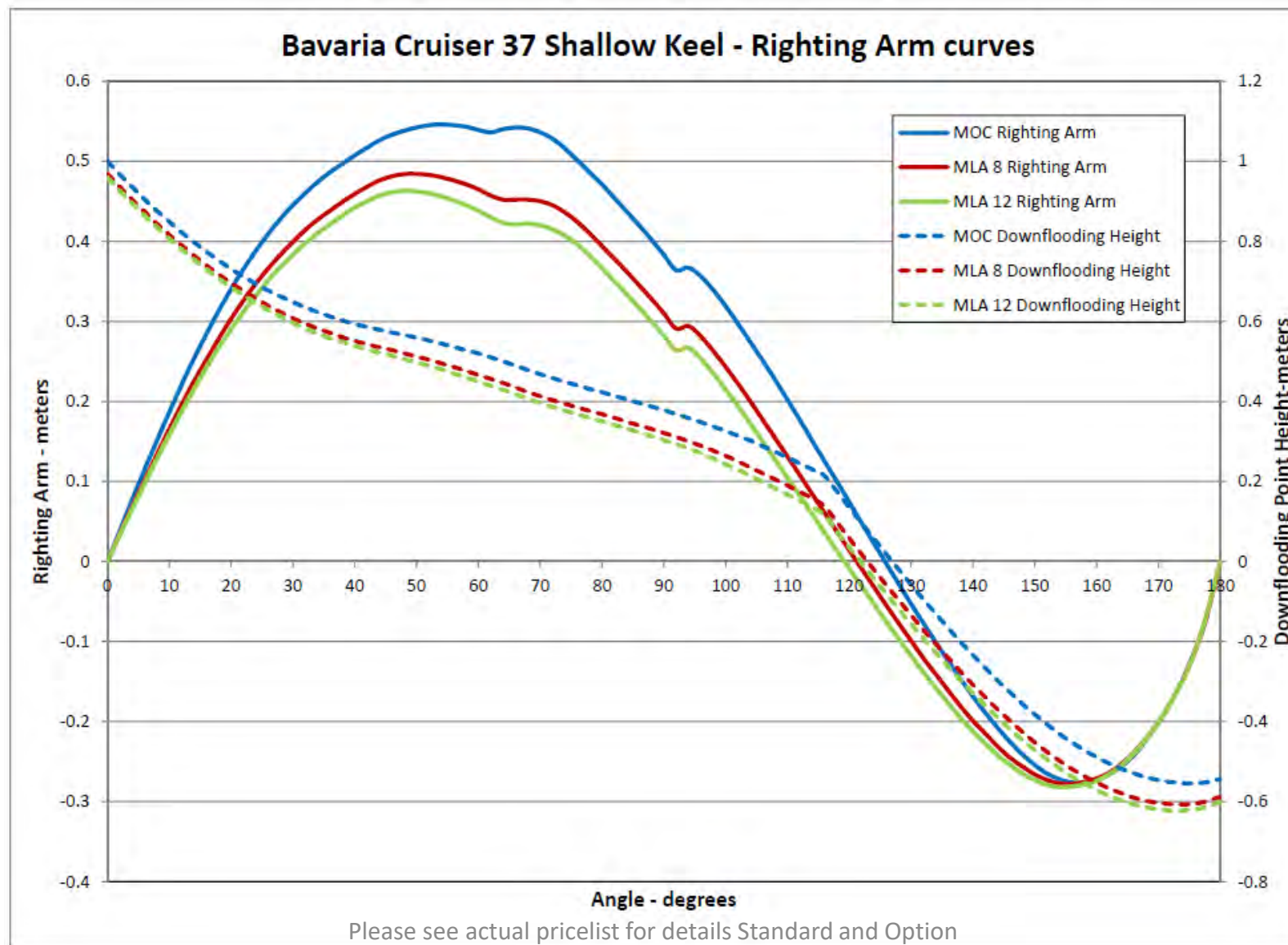

2.4 Deck

- Deck in hand lay-up sandwich construction, cockpit floor, side decks and coach roof with non-slip structure
- GRP deck innerliner, signal white
- GRP anchor hatch
- Teak on cockpit benches and bathingplatform

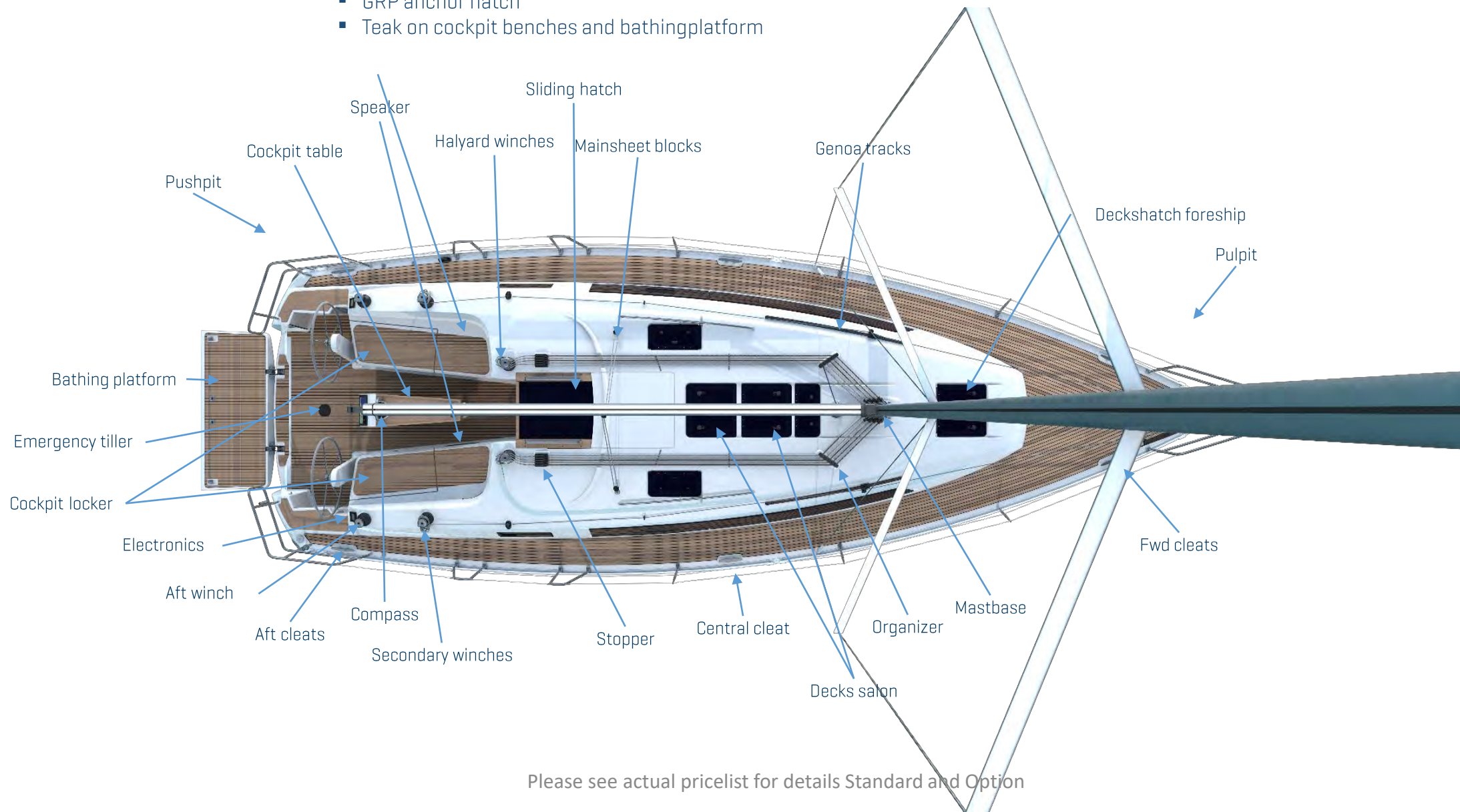

Please see actual pricelist for details Standard and Option

2.4 Deck

- Teak on cockpit floor
- Teak on cockpit floor and side deck
- DuraDeck on cockpit seats and bathing platform
- DuraDeck on cockpit seats, bathing platform and cockpit floor
- DuraDeck on cockpit seats, bathing platform, cockpit floor and side deck

- Teak or DuraDeck option
- DuraDeck according to BAVARIA Style Guide
- Division in separate areas – Side deck, Cockpit benches and Cockpit Bottom

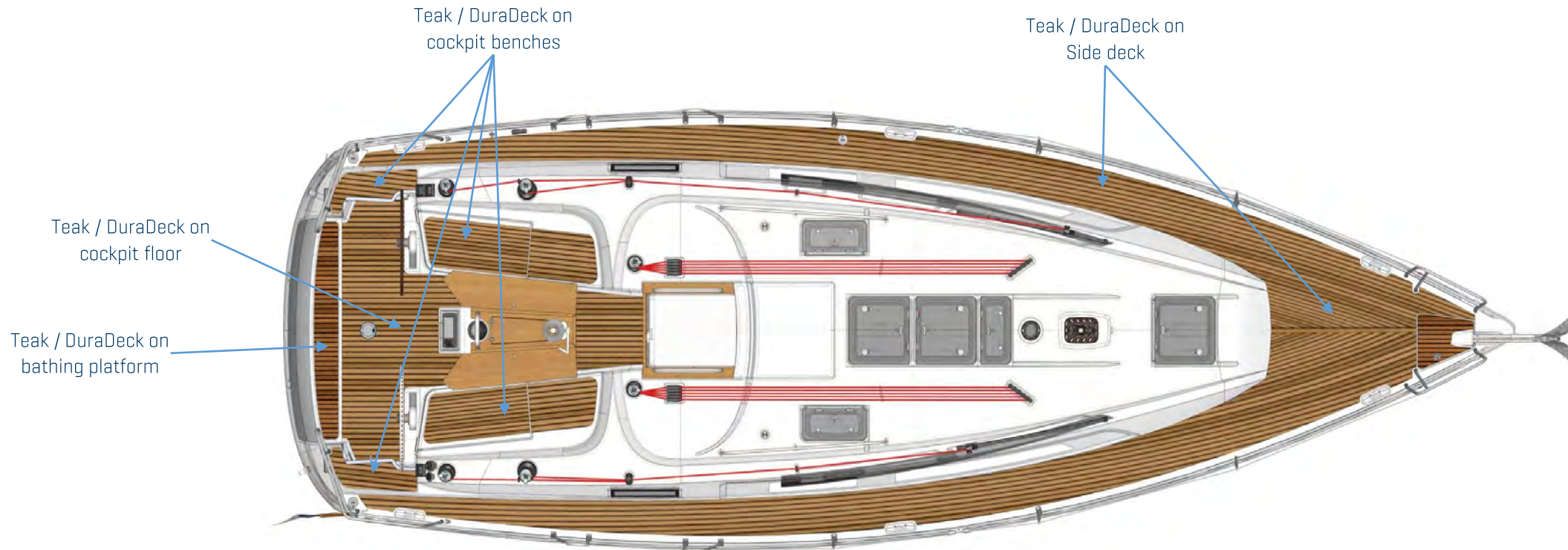

Please see actual pricelist for details Standard and Option

4.4 Cockpit & Deck

- Deck in hand lay-up sandwich construction, cockpit floor, side decks and coach roof with non-slip structure
- GRP deck innerliner, signal white
- GRP anchor- and sail locker hatch
- Cockpit locker on portside
- Cockpit locker on starboard
- Gas box in cockpit
- Teak on cockpit benches

- GRP deck with integrated footrail at sides and antislip surfaces
- Coachroof extended as central footrail
- 2 deck lockers in cockpit and sail locker forward with anchor chain locker
- GRP deck innerliner with antireflex structure
- Teak on cockpit benches

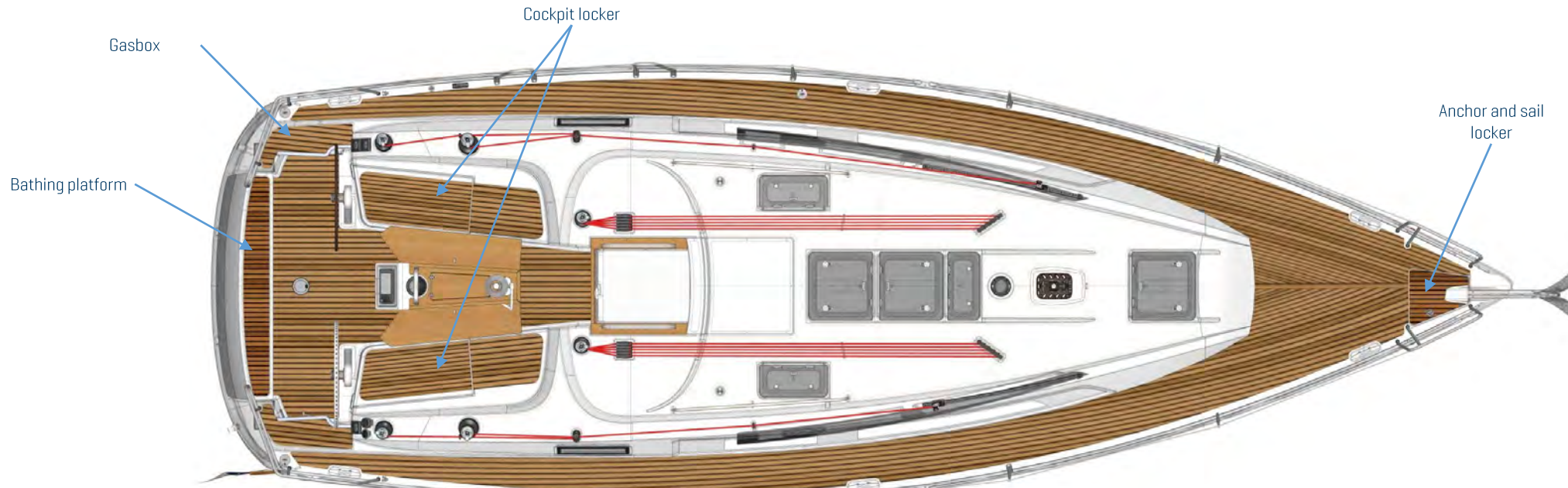

Please see actual pricelist for details Standard and Option

2.4 Deck

- 6 stainless steel cleats
- Anchor windlass, electric
- “Delta” anchor 10 kg and anchor chain, galvanised, Ø 8 mm, 50 m
- “Delta” anchor 10 kg and anchor chain, stainless steel, Ø 8 mm, 50 m
- Mooring kit [4 fenders and 4 mooring lines]

- Anchor system with stainless steel arm
- Electric anchor windlass
- Delta anchor galvanised or ultra anchor stainless steel
- Anchor chain 8mm, 50m galvanised or optional stainless steel
- Wired remote control with chain counter in chain locker



Gennaker tack

Front opened pullpit

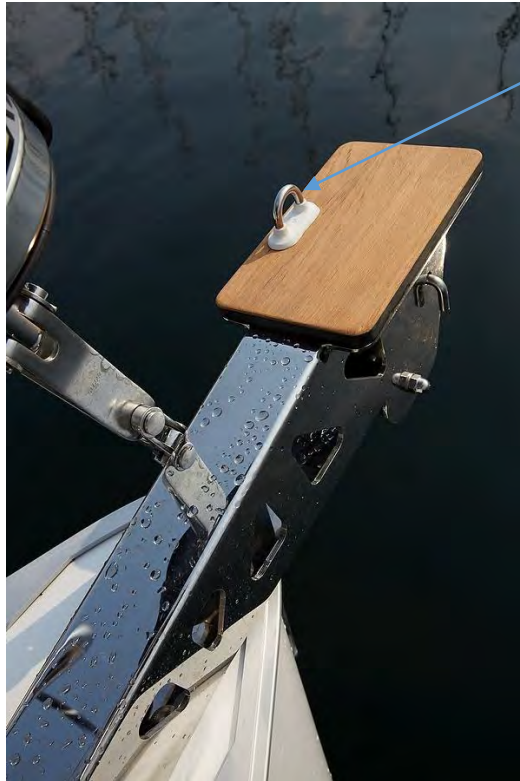

Please see actual pricelist for details Standard and Option

2.5 Cockpit

- Cockpit table

- Cockpit table with compass and handhold
- Storage possibility for glasses



- GRP cockpit table with storage, foldable

- Foldable cockpit table with GRP body and teak leaves with stainless steel support and mechanics
- Stowage box from top with hinged cover
- Integrated light (removable)
- Optional chart plotter integrated

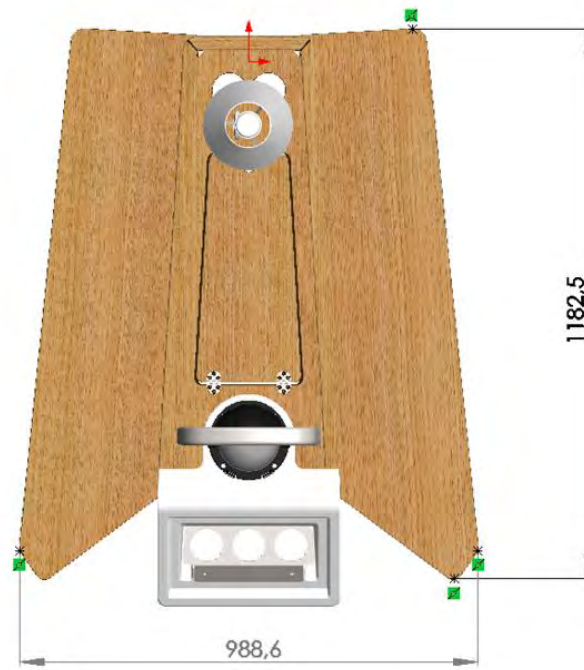

Please see actual pricelist for details Standard and Option

2.5 Cockpit

- 2 x Aluminium halyard winches (30), self-tailing
 - 2 x Aluminium genoa winches (40), self-tailing
 - 2 x gennaker winches, aluminium, selftailing
 - 2 x genoa winches, upgraded in size, aluminium, selftailing
 - Genoa winches placed aft
-
- Additional gennaker winch aft on each side for gennaker sailing
 - Genoa winches placed aft for easy “one hand” sailing

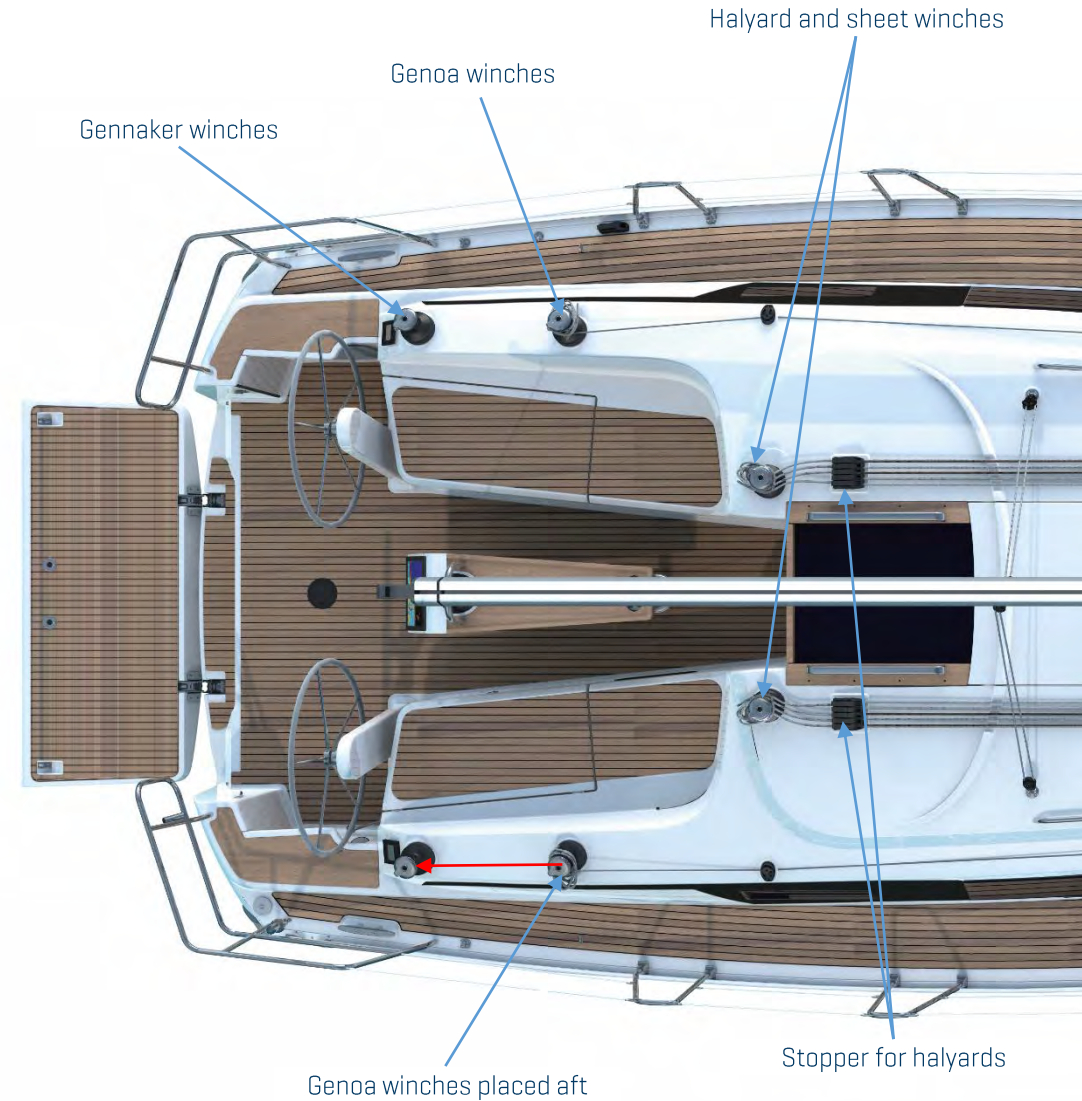

Please see actual pricelist for details Standard and Option

2.5 Cockpit

- Sprayhood with handhold [COMFORT PLUS]
 - Bimini
 - Bimini with LED overhead lights
 - Upholstery on seat in cockpit and 4 scatter cushions [according to BAVARIA Style Guide]
 - Textile covers for steering wheel, cockpit table and all winches [according to BAVARIA Style Guide]
 - Textile cover for rolled-up jib on forestay [according to BAVARIA Style Guide]
-
- Sprayhood with handhold
 - Bimini for optimal sun protection
 - Bimini with LED overhead light for sun protection and optimal light in the night
 - Textile covers for steering wheels, cockpit table and all winches for optimal UV-protection in the harbor
 - Textile cover for the jib for optimal UV-protection in the harbor



2.5 Cockpit

- Bathing platform
 - Emergency boarding ladder
-
- Swimming ladder, foldable with teak steps
 - Pull out emergency ladder



Emergency ladder

Connection for the swimming ladder



2.6 Rigg & Sailplan

- LED Navigation lights
- Sportmast on deck stepped 2 spreader, aluminium
- Backstay adjuster, mechanical
- Rod kicker (optional)
- Wind indicator
- Running rigging

- 9/10 Rigging
- Deck stepped
- Swept Spreaders
- Discontinuous ("linked") Rigging
- 2 Spreader pairs
- Furlex 204S Series headstay furler

Deck-stepped mast



Fractional rig

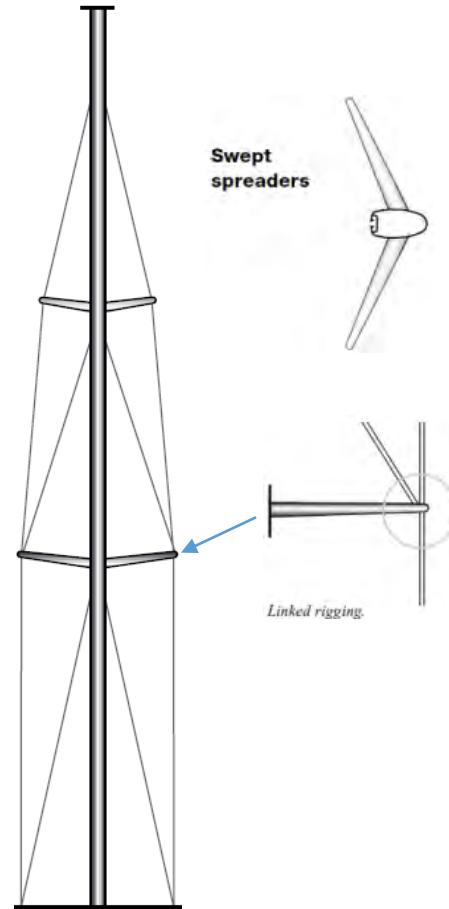
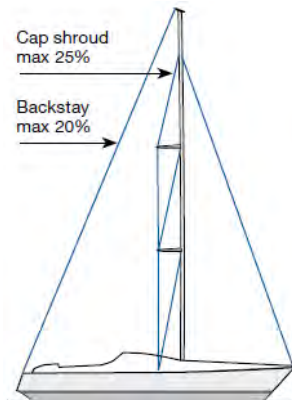
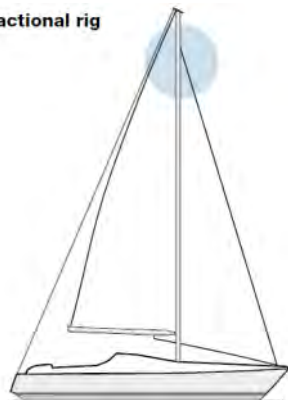

Please see actual pricelist for details Standard and Option

2.6 Sail Plan – Sport Mast

Mainsail (standard)	40.7 m ²	495 sq.ft
Selftacking jib	-	-
Genoa (106%)	26.7 m ²	287 sq.ft
Gennaker	81.8 m ²	880 sq.ft
Code0	-	-
Mast height above WL	17.20 m	56' 43" ft
I	14.06 m	46' 13" ft
J	3.73 m	12' 24" ft
P	13.58 m	44' 55" ft
E	5.10 m	16' 73" ft



Please see actual pricelist for details Standard and Option

2.6 Sail Plan – Sport Mast – VPP

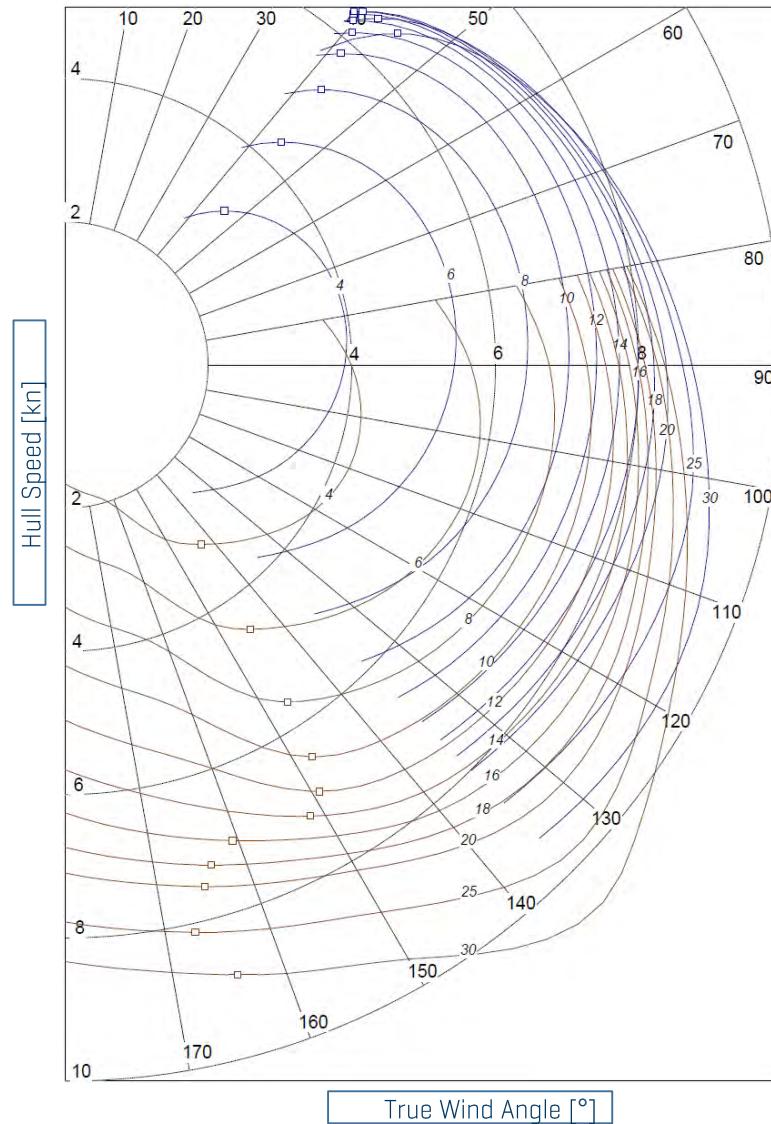

Sail Configuration:

Standard Draft
Mainsail
106% Genoa
Gennaker

True Wind Speed [kn]

4 kn
6 kn
8 kn
10 kn
12 kn
14 kn
16 kn
18 kn
20 kn
25 kn
30 kn

Please see actual pricelist for details Standard and Option

2.6 Sail Plan – Furling

Mainsail (furling)	34.0 m ²	366 sq.ft
Selftacking jib	-	-
Genoa (106%)	26.7 m ²	287 sq.ft
Gennaker	81.8 m ²	880 sq.ft
Code0	-	-
Mast height above WL	17.20 m	56' 43" ft
I	14.06 m	46' 13" ft
J	3.73 m	12' 24" ft
P	13.58 m	44' 55" ft
E	5.10 m	16' 73" ft



Please see actual pricelist for details Standard and Option

2.7 Standing & Running Gear

MAINSAILS – STANDARD MAST

- Elvström mainsail and self-tacking jib – Cruisetech Dacron
 - 9/10 standard main sail
 - Sail area: 40,70m²
 - Material: Dacron 380
 - Layout Cross cut
 - Short battens
- Elvström fully battened mainsail with MDS-system and 2 reefs – Cruisetech Dacron
 - 9/10 standard main sail
 - Sail area: 40,70m²
 - Material: Dacron 380
 - Layout: Cross cut
 - Full battened
 - 2 reefs
 - MDS -slider
- Elvström mainsail & self-tacking jib – Sporttech trioptimal laminate
 - 9/10 battened main sail
 - Sail area: 40,70m²
 - Material: Polyester laminate grey
 - Layout: trioptimal
 - Full battened
 - 2 reefs
 - MDS-slider



2.7 Standing & Running Gear

MAINSAILS – FURLING MAST

- Elvström furling mainsail and self-tacking jib – Cruisetech Dacron
 - Furling standard main sail
 - Sail area: 43,00 m²
 - Material: Dacron 380
 - Layout: Cross cut
 - No battens
 - UV-protection in grey
- Elvström mainsail & self-tacking jib – Sporttech trioptimal laminate
 - Furling main sail
 - Sail area: 39,90 m²
 - Material: Polyester laminate grey
 - Layout: trioptimal
 - Vertical full battened
 - UV-protection grey



2.7 Standing & Running Gear

GENOAS

- Elvström 106% genoa - Cruisetech Dacron
 - Furling 106% jib
 - Sail area: 26,70 m²
 - Material: Dacron 380
 - Layout: Cross cut
 - No battens
 - UV-protection Grey
- Elvström 106% genoa - Sporttech trioptimal laminate
 - Furling 106% jib
 - Sail area: 27,30 m²
 - Material: Polyester Laminate
 - Layout: Trioptimal
 - Vertical battens
 - UV-protection Grey



2.7 Standing & Running Gear

GENNAKER

- Gennaker, trioptimal + Snuffer
 - Gennaker
 - Sail area: 81,90 m²
 - Material: Nylon 0,9 oz
 - Layout: Trioptimal
 - Snuffer
 - Unicolor White/grey or Blue
- Gennaker equipment consisting of sheets, blocks, halyard, halyard clutch and bow chain plate with single anchor roller and pad eye for gennaker tack



2.7 Standing and Running Gear

- Sport Mast

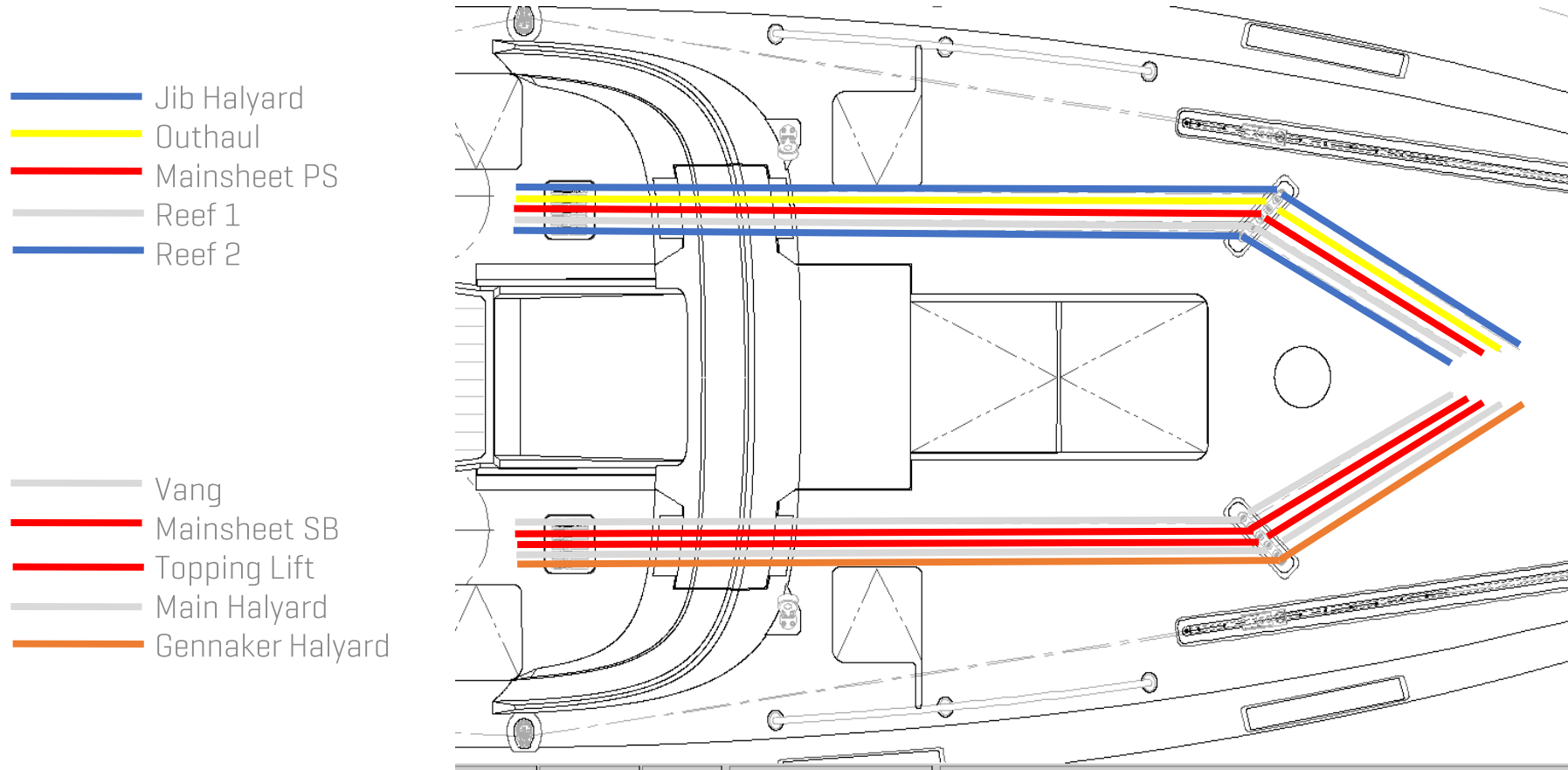

Please see actual pricelist for details Standard and Option

2.7 Standing and Running Gear

- Furling Mast

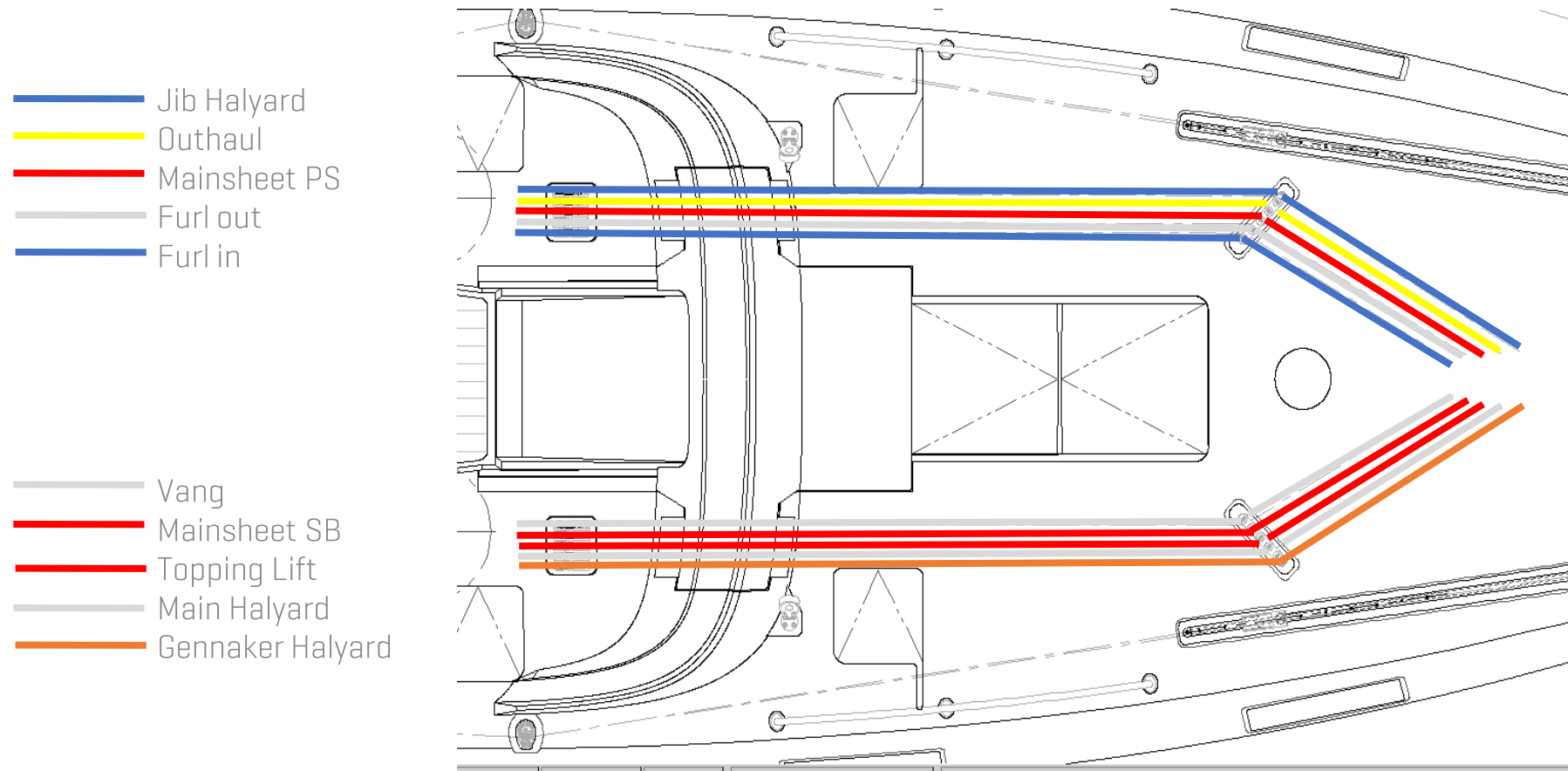

Please see actual pricelist for details Standard and Option

2.8 Main Sheet

- “Double Main Sheet System”
 - Good trim options with 2 sheets
 - better upwind performance



Please see actual pricelist for details Standard and Option

2.8 Main Sheet

- “Single Main Sheet System”
→ easy handling with 1 sheet



Please see actual pricelist for details Standard and Option

3.0 Interior

3 INTERIOR

- 3.1 Interior Layout
- 3.2 Standing Heights
- 3.3 Layout B
- 3.4 Layout C
- 3.5 Layout D



Please see actual pricelist for details Standard and Option

3.1 Interior Layout

CABIN 3 - HEAD 1

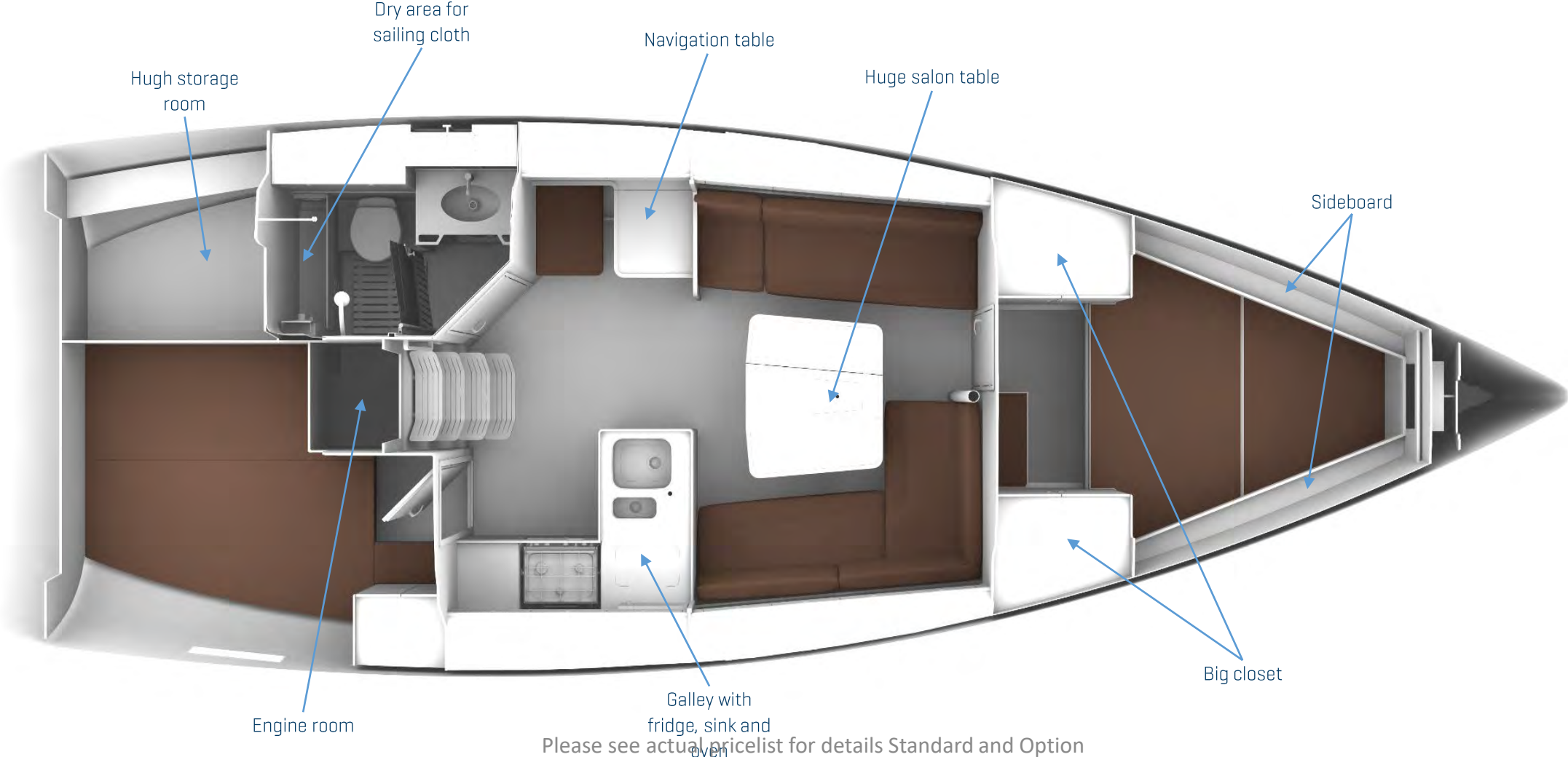

Please see actual pricelist for details Standard and Option

3.1 Interior Layout

2 CABIN – 1 HEAD

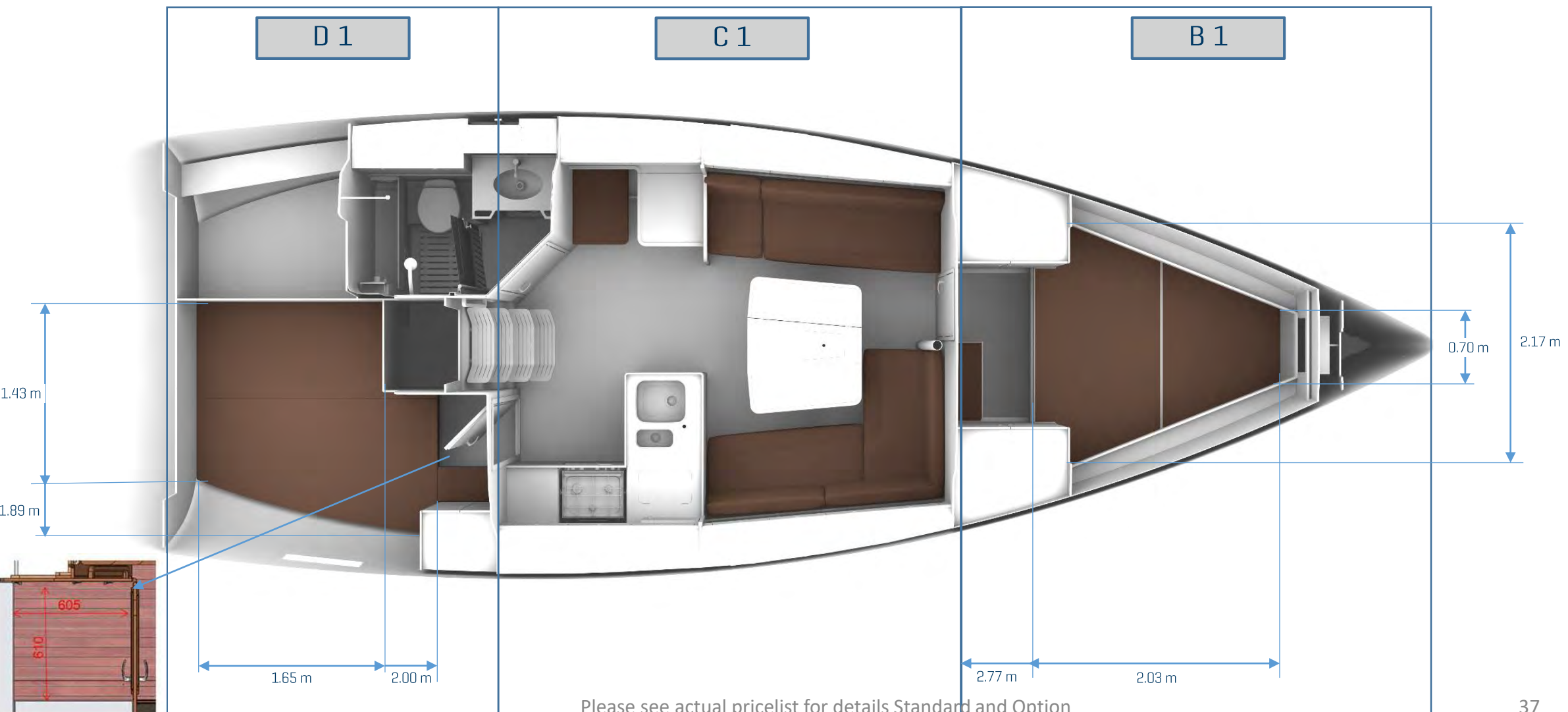

Please see actual pricelist for details Standard and Option

3.1 Interior Layout

3 CABIN – 1 HEAD

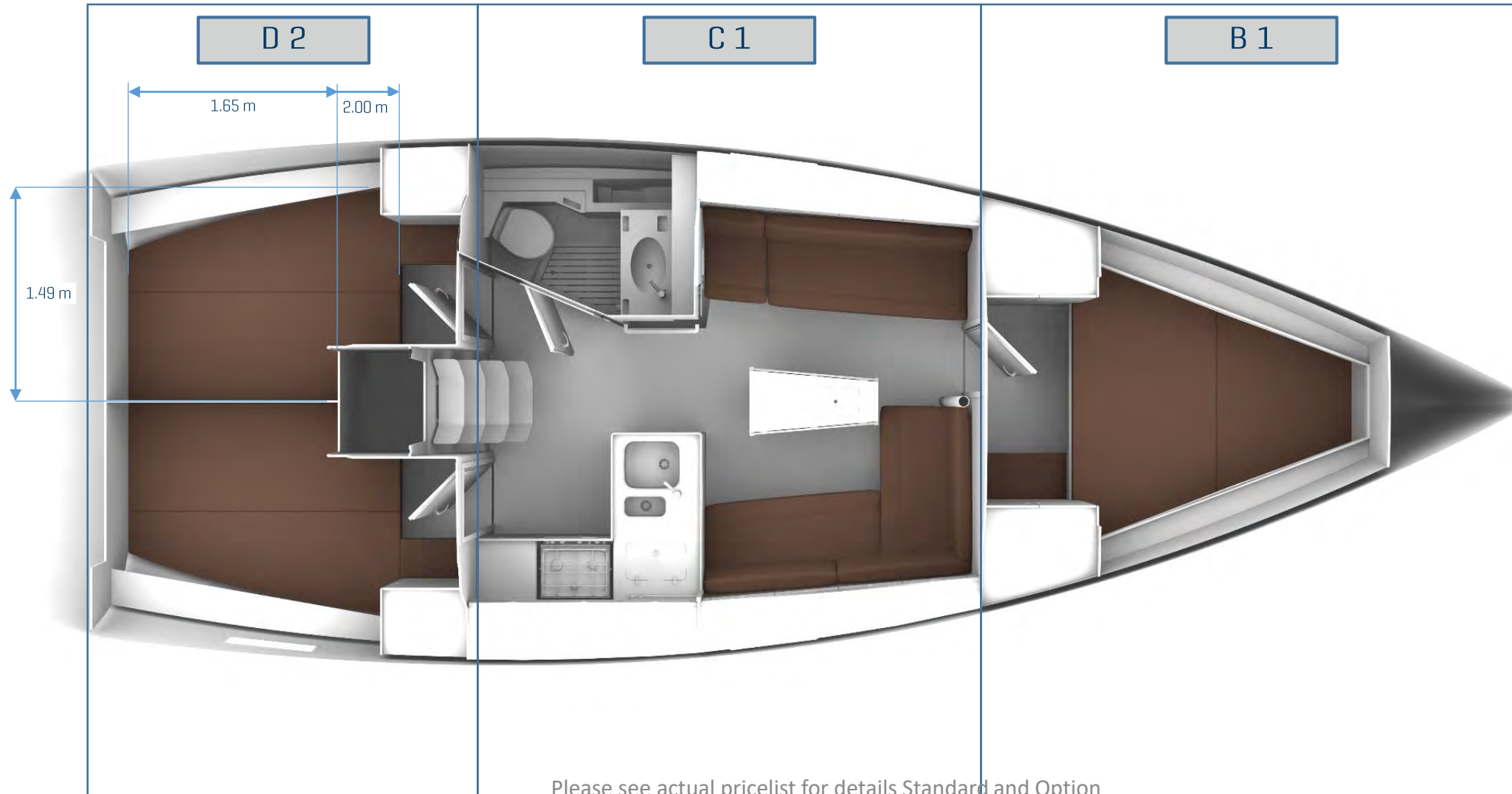

Please see actual pricelist for details Standard and Option

3.2 Standing heights

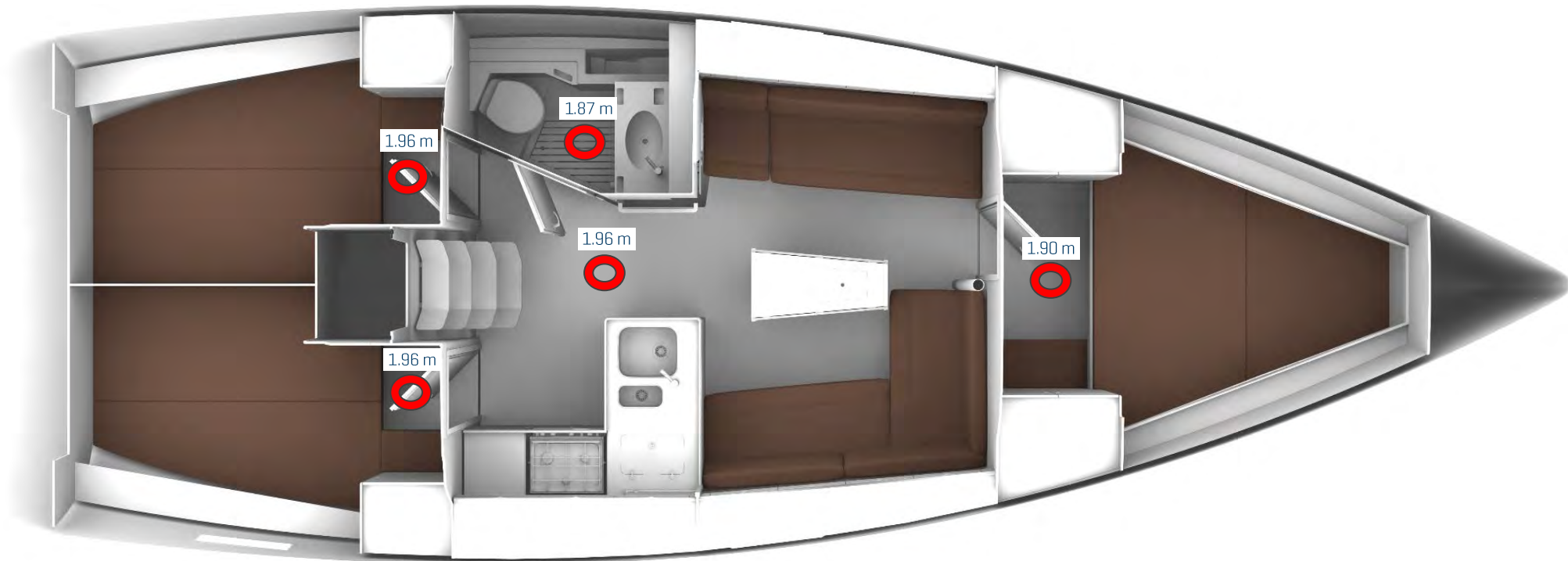

Please see actual pricelist for details Standard and Option

3.3 Layout B1

- Master cabin with master double berth and storage
 - Master bed 2.00 x 2.00 m
 - Huge twin door cupboard both sides
 - Shelves above bed at side
 - Storage below bed
 - Reading lights with USB port for charging and LED spotlights
 - 230 V power plug next to bed
 - Hull windows with optional blinds both sides
 - Hatch above bed with emergency exit step



3.4 Layout C1

- L-shaped sofa on starboard
- Sofa on port with big chart table / desk in boat direction with integrated separate slot for navigation charts and reading light with USB slot for charging on port
- Fixed chart table portside [foldable in 3 cabin version]
- Upper cupboards above sofas both sides
- Shelves behind sofas
- Smoke detector
- Salon table, fix with storage
- Storage below sofas and backrests
- Hull windows with optional blind and ambient light both sides
- 12 and 230 V power plug at chart table
- Reading lights on the main bulkhead
- Companion way with 5 stairs, openable for access to engine compartment



Foldable
charttable

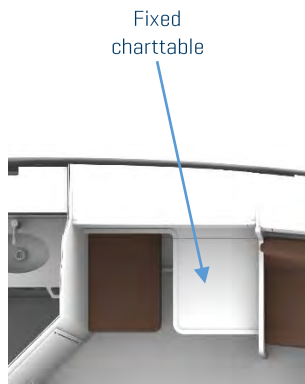

Fixed
charttable



3.4 Layout C1

- Starboard sofa in salon transformable into double berth
- Cushion for additional double berth

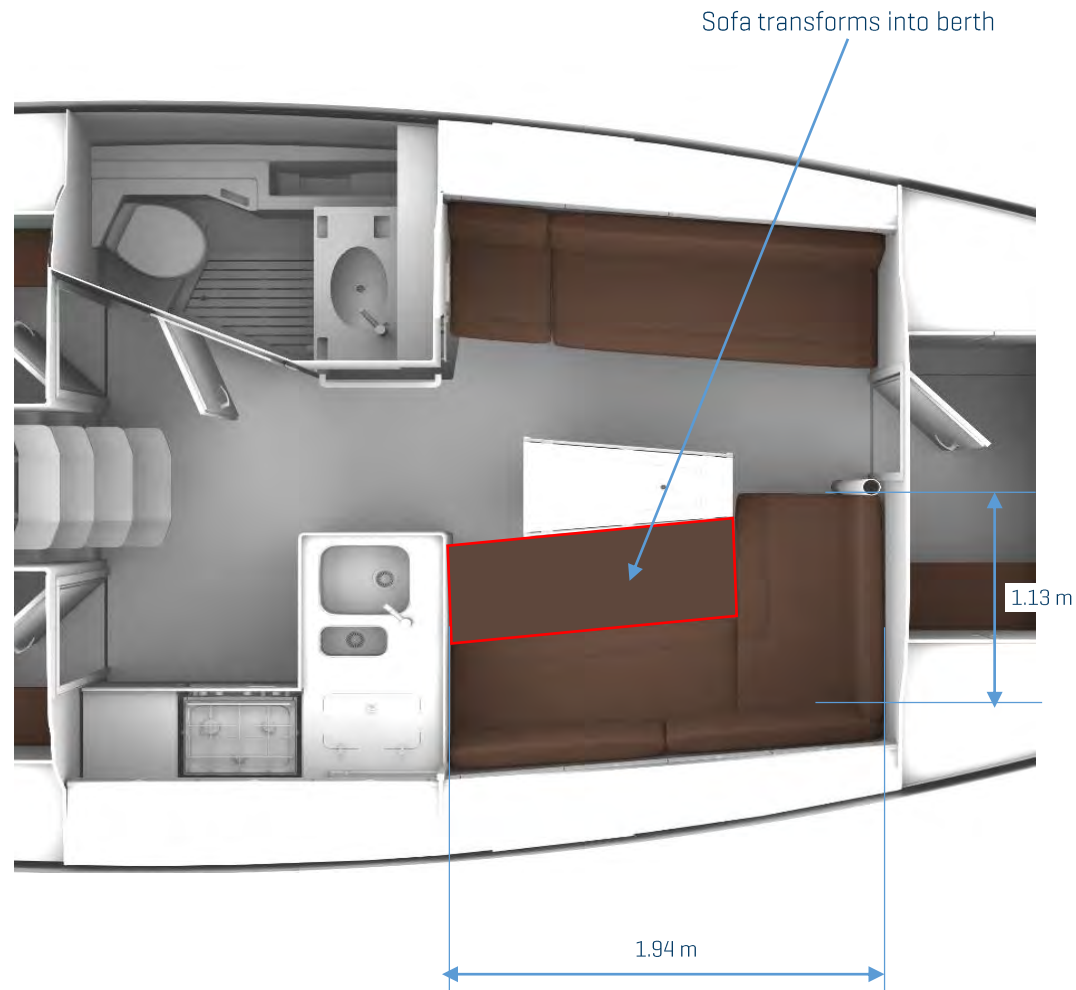

Please see actual pricelist for details Standard and Option

3.4 Layout C1

- Separate head with washing basin, toilet and shower unit
- Modern appeal with concrete look wall panels in shower
- Shower door in glass with stainless steel look [2 cabin version]
- Shower panel
- Upper and lower cupboard at washing basin with tap
- Mirror at bulkhead next to washing basin
- Hatch for ventilation in coachroof window
- Big storage room for sailing clothes [2 cabin version]
- 70 L black water tank



Please see actual pricelist for details Standard and Option

3.4 Layout C1

- L-shaped galley
- Galley with upper cupboards, lower cupboards and 4 additional drawers
- 147 L top opening fridge with small icebox
- Double stainless steel washing basin with tap
- Shelve at hull side
- Waste bin in pantry
- Rotatable 2 or 3 burner gas stove with additional handrail
- Microwave 230V

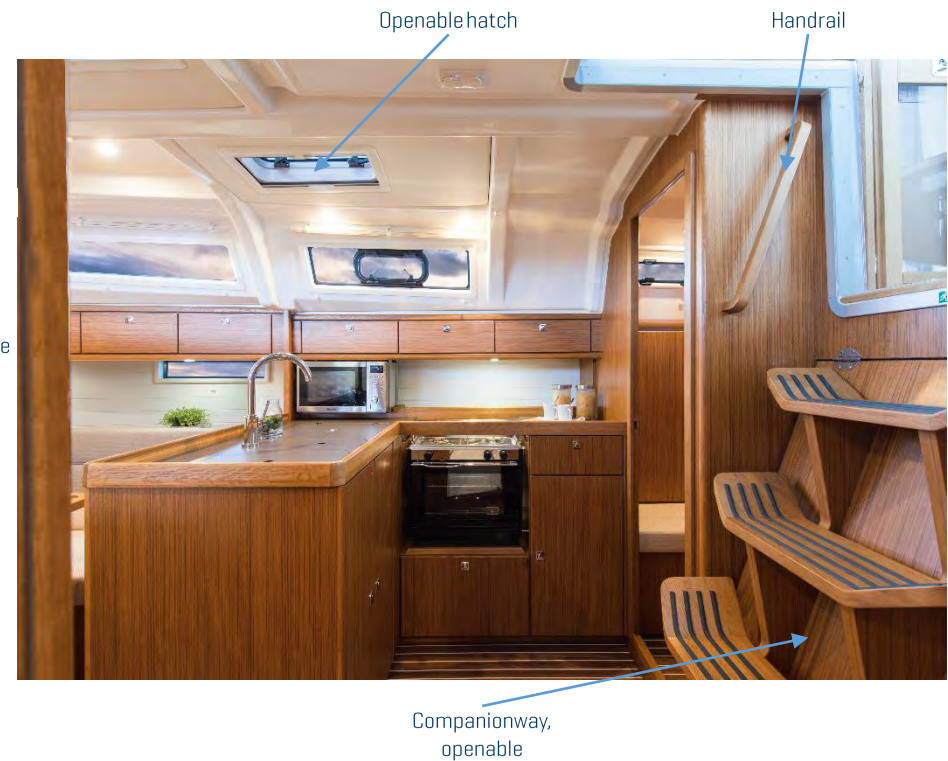

Please see actual pricelist for details Standard and Option

3.5 Layout D1

- Aft cabin with double berth and storage space on stb
- Utility room port aft with access from cockpit
- Bigger head on portside, with shower door
- Rectangular bed approx. 1.55 x 2.05 m
- Huge cupboard
- Shelves above bed at side
- Reading lights with USB port for charging and LED spotlights

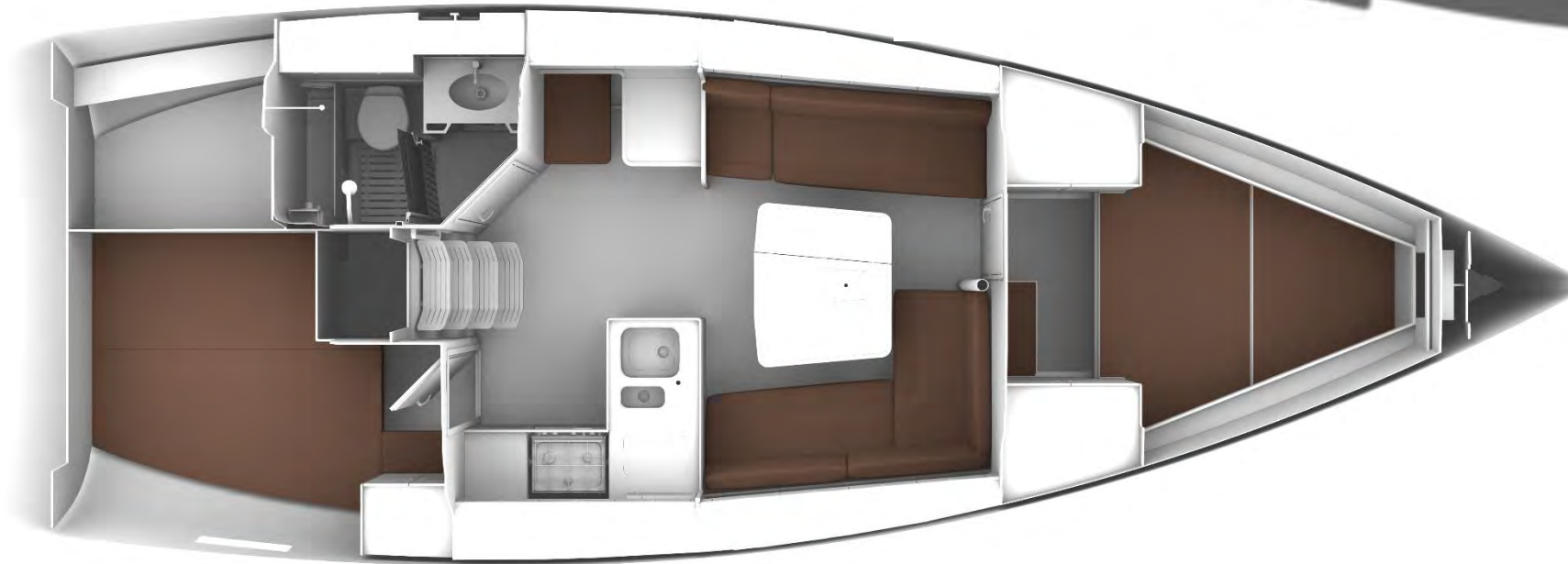

Please see actual pricelist for details Standard and Option

3.5 Layout D2

- Aft cabin with double berth and storage space on portside
- Rectangular bed 1.48 x 2.00 m
- Huge closet
- Shelves above bed at side
- Reading lights with USB port for charging and LED spotlights



Please see actual pricelist for details Standard and Option

4.0 Technic / Systems

4 SYSTEMS

- 4.1 Steering system
- 4.2 Electrical system
- 4.3 Navigation equipment
- 4.4 Entertainment system
- 4.5 Equipment water
- 4.6 Equipment heating
- 4.7 Propulsion



Please see actual pricelist for details Standard and Option

4.1 Steering System

- Single GRP rudder with aluminum stock
 - Twin wheel steering system with emergency tiller
 - GRP sport steering wheels in black or white
 - Autopilot Jefa Direct Drive
- Optimized GRP single rudder with special aluminum stock
 - Twin wheel steering system with pedestals accessible from cockpit with GRP cover
 - Lowest possible draft for highest possible internal stability
 - Emergency tiller mountable from top with additional hatch from top

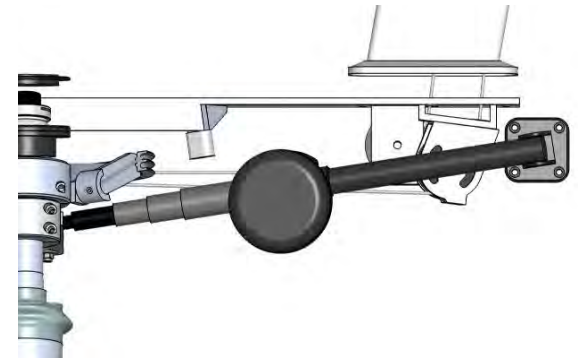
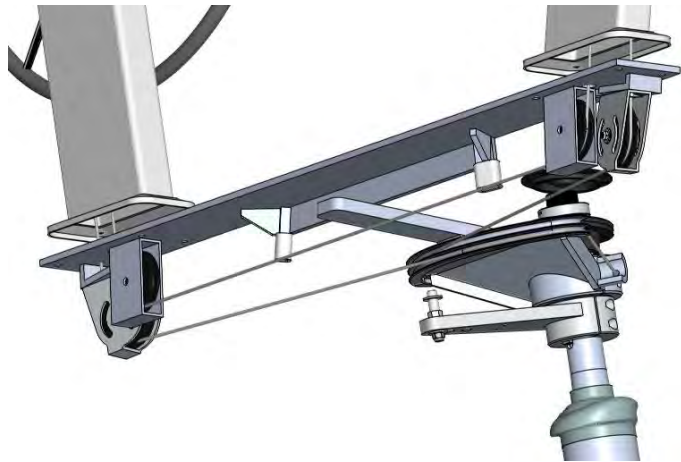

Please see actual pricelist for details Standard and Option

4.1 Steering System

- GRP steering wheels, black or white
- GRP steering wheel, dia. 800mm, in black or white color - according to Bavaria Style Guide



GRP Steering Wheels
- Gelcoat White -



GRP Steering Wheels
- Gelcoat Black -

- Textile covers for steering wheel, cockpit table and all winches
- Steering wheel covers according to Bavaria Style Guide



4.2 Electrical System

- Inverter 2500W [true sine wave] for 230V Shore power
- Inverter 2000W [true sine wave] for 110V Shore power
- Shore power supply 110 V

Pos	Description
1	Air condition
2	230V/110V-panel
3	Microwave
4	Water pump for air condition
5	Shore power service
6	Shore power air-conditioning
7	Sockets
8	RCD circuit breaker
9	Batterie charger
10	Socket for water heater
11	Operating panel air condition

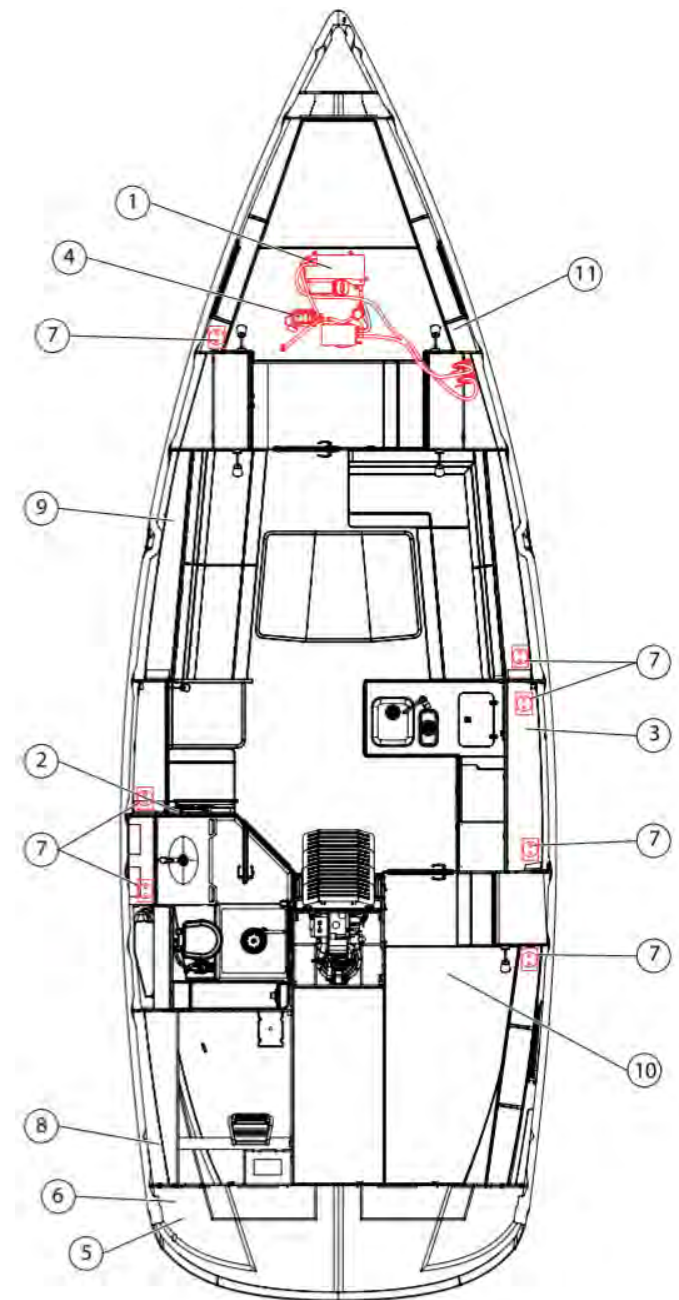
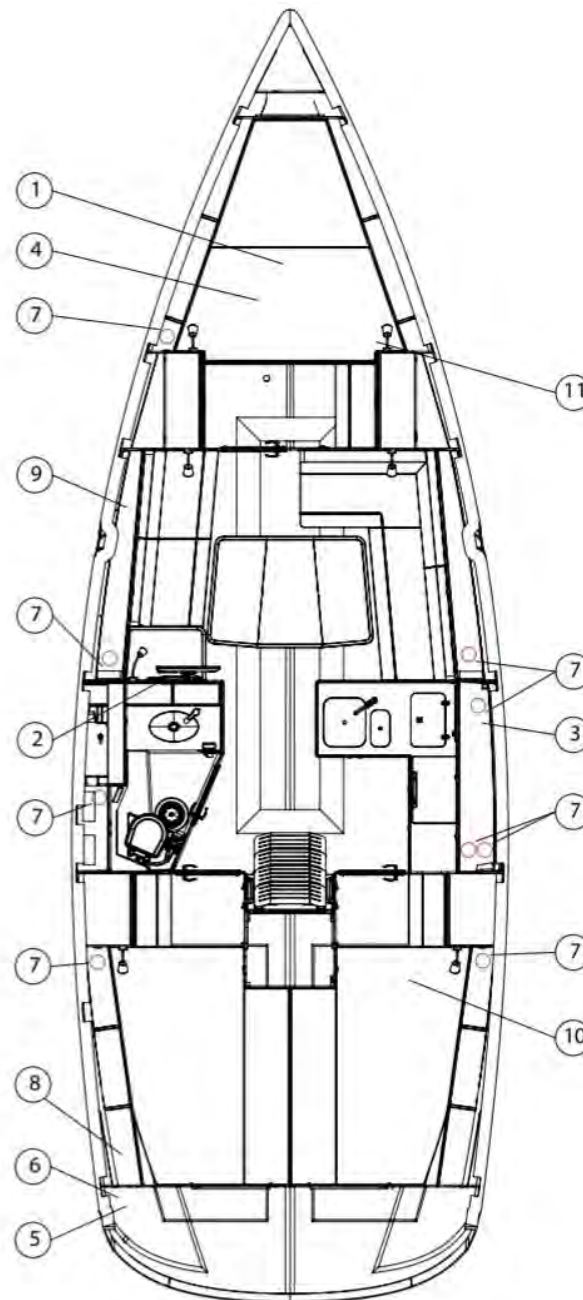

4.2 Electrical System

- Country Version EU or US/JPN
- 12V electrical main panel
- 230V or 110V electrical main panel, AC socket in each cabin and head, in pantry (2) and at chart table
- 1 x engine battery, 12 V / 70 Ah, AGM
- 3 x service batteries, 12 V / 95 Ah, AGM
- 1 x bow thruster battery, 12 V / 95 Ah, AGM
- Battery charger, 40 Ah [3 channels]
- Shore power

	Screen
1	Service batteries
2	Bow-thruster/anchor-system battery
3	Engine battery
4	Generator
5	Freshwater tank 1
6	Fresh water tank 2
7	Greywater tank 1
8	Greywater tank 2

	NAVIGATION	SYSTEMS	INTERIOR
1	Top / Anchor Light	Fridge - Interior	Salon Lights
2	Spreader Lights	Fridge - Exterior	Cabin Lights
3	Navigation Lights - Sailing [red/green, transom]	Fresh Water Pump	Cockpit / Bimini Lights
4	Navigation Lights - Engine [red/green, transom, steam]	Shower Pump	HiFi System
5	Underwater Lights	Grey-Water Pump	TV System
6	Compass Lights	Heating System	Cooking Extractor Hood
7	Navigation Instruments	Anchor System	-
8	-	-	-
9	-	-	-

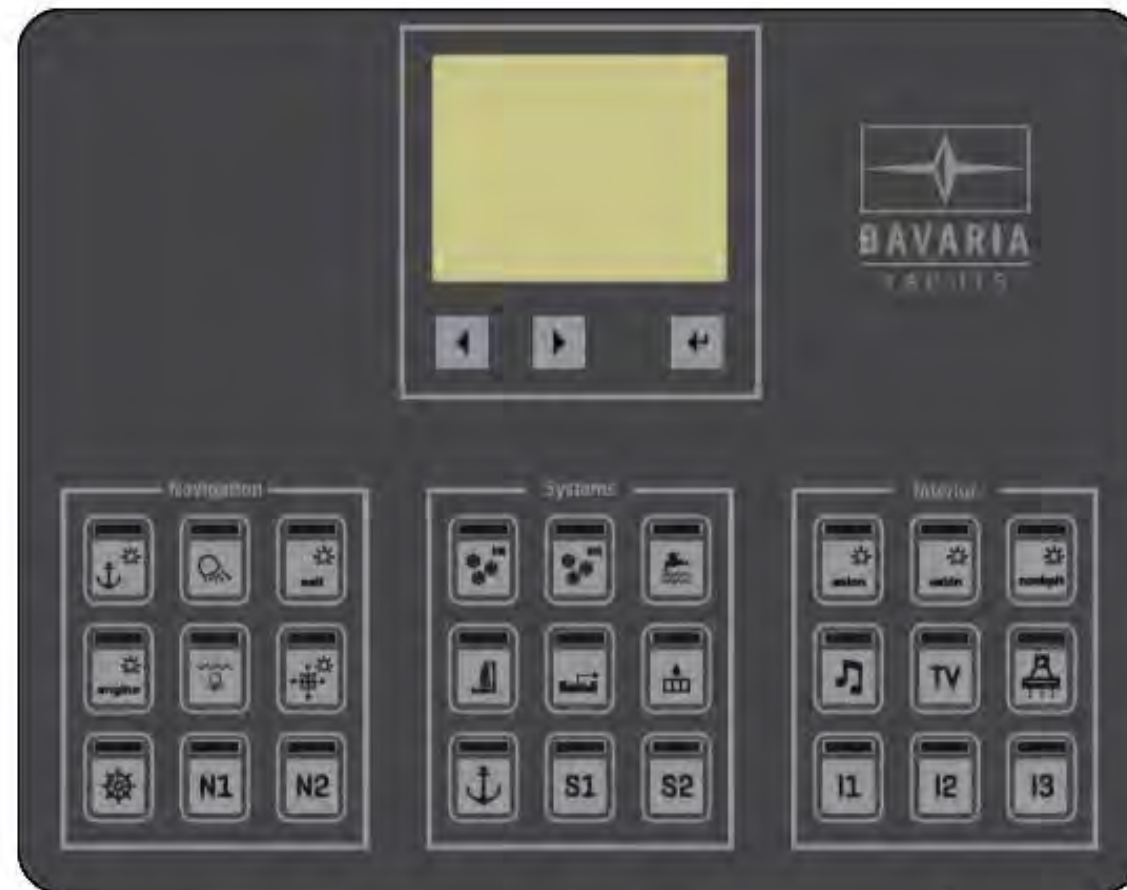

4.3 Navigation Equipment

NAV pack & Upgrade

Basic

Cockpit 1x Zeus³ 7" Triton2 Port Triton2 Starboard WS 310 VHF V60 + H60

DST810

Advanced

Cockpit 1x Zeus³ 7" Triton2 Port Triton2 Starboard WS 310 VHF V60 + H60

DST810

Autopilot NAC2
P9 compass
WR10 Remote

Premium

Cockpit 1x Zeus³ 9" Triton2 Port Triton2 Starboard WS 310 VHF V60 + H60

DST810

Autopilot NAC2
P9 compass
WR10 Remote

Single Picks

For all Packs available!

NAIS500 NSPL500

Halo 20+ Radar

Forward Scan with Sonar Hub

Please see actual pricelist for details Standard and Option

4.4 Entertainment Systems

- Fusion MS-RA770 unit incl. Bluetooth streaming, dual USB; Multi-Zone technology, at chart table, Radio with DVD player function and colour display with 2 speakers in salon and cockpit, remote control in cockpit, connected with NMEA Network
- TV preparation in salon with digital and analog cabling incl. antenna

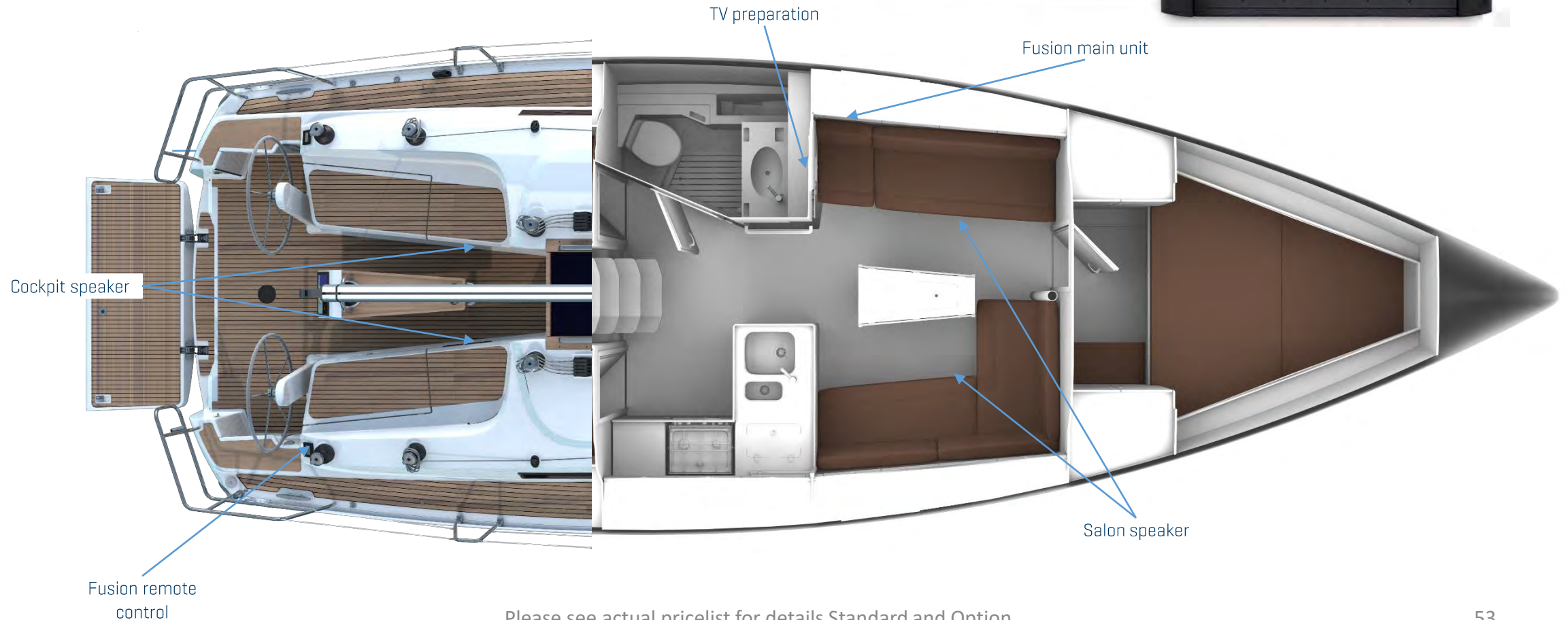

Please see actual pricelist for details Standard and Option

4.5 Interior Equipment – Water

- 150 L additional fresh-water tank below forward berth
- Water heater, 20 L
- Electric toilet, large \varnothing 38cm, aft

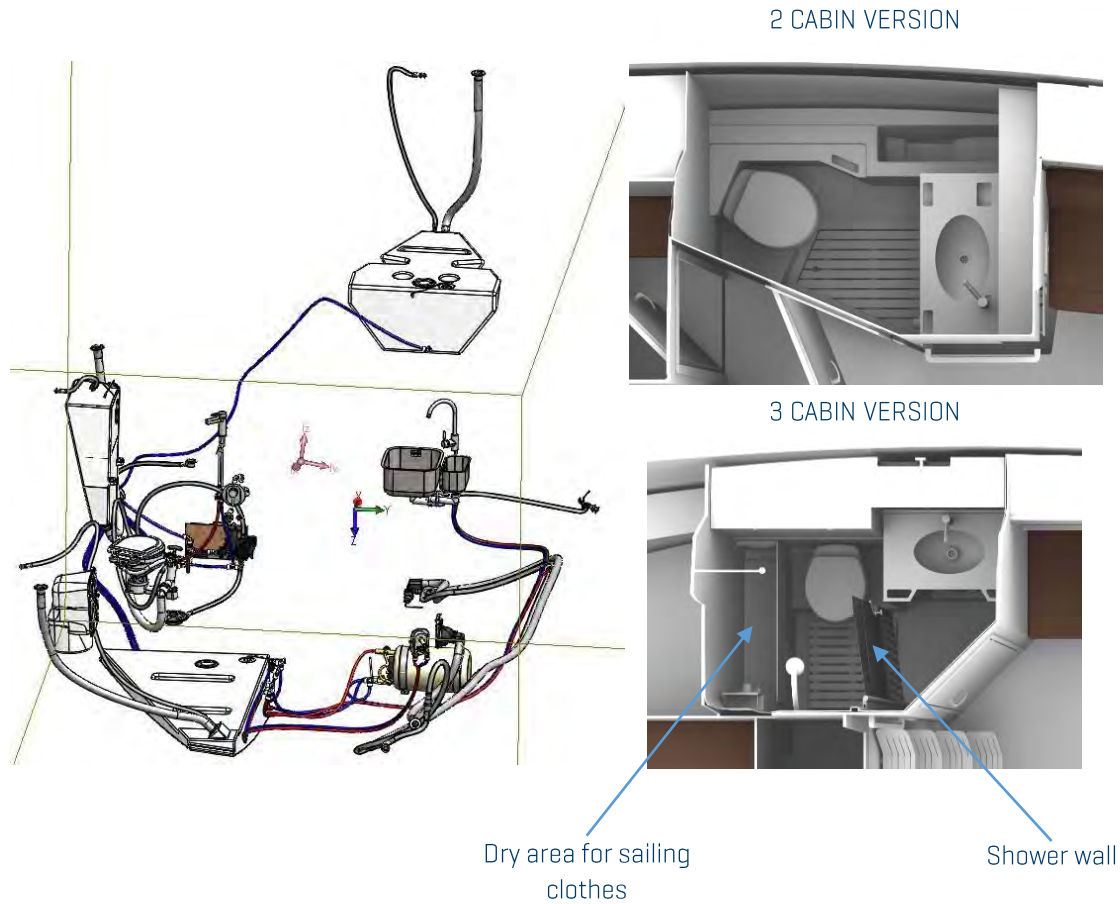

Openable coachroof window

Locker

Sink

Mirror

Openable hatch



Tray for shampoo etc.

Please see actual pricelist for details Standard and Option

4.6 Interior Equipment – Fresh Air

- Air Conditioner, Reverse Cycle, 12.000 BTU, 1 Unit for salon, foreship cabin and aft cabin[s], incl. 2nd shore power, 110V
- Air Conditioner, Reverse Cycle, 13.000 BTU, 1 Unit for salon and foreship cabin, incl. 2nd shore power, 230V

- Approx volume bow cabin : 6,5 m³
- Approx volume salon area : 15 m³

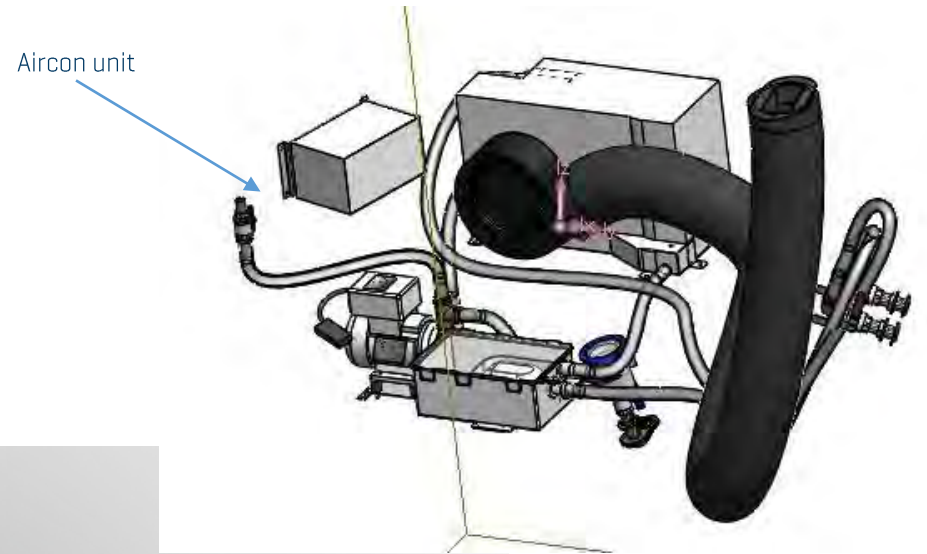

Please see actual pricelist for details Standard and Option

4.6 Interior Equipment – Heating

- Hot air heating, 4,0 kW, 1 Unit for salon and foreship cabin

- Webasto Airtop Evo 40
- Approx volume bow cabin : 6,5 m³
- Approx volume salon area : 15 m³



Model	Webasto Air Top Evo 40
Heat output (kW) (BTU/h)	1,5 – 3,5 (4,0) 5,100 – 12,000 (13,600)
Fuel	Diesel
Fuel consumption (l/h)	0,18 – 0,43 (0,49)
Rated voltage (V)	12, 24
Rated power consumption (W)	15 – 40 (55)
Dimension l x W x H (mm)	473 x 148 x 167
Net weight (kg)	5,9

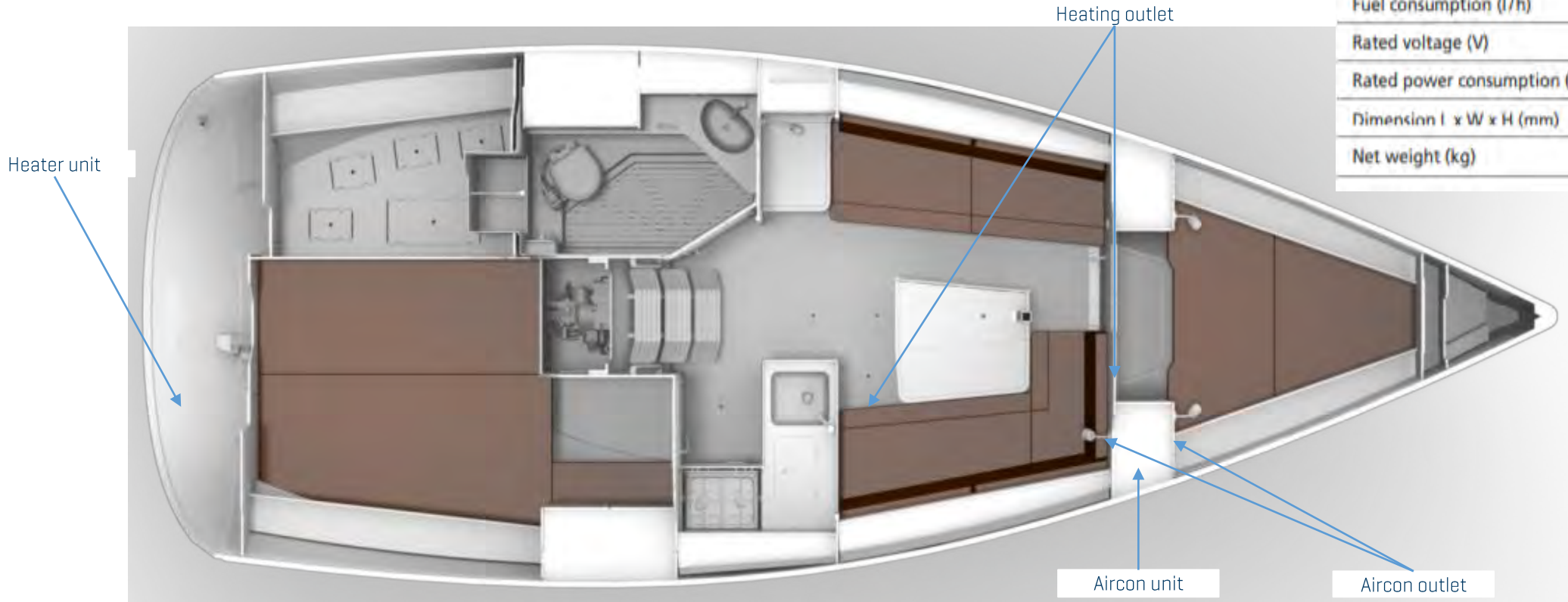

Please see actual pricelist for details Standard and Option

4.7 Propulsion

- Diesel engine, 20.9kW / 28 hp, sail drive
- 2 blade fixed propeller
- Volvo-Penta D1-30 diesel engine with 21.3kW / 29.1hp with SD25 saildrive
- Electronic engine panel for start and stop and all engine and fuel information
- Separate circulation for fresh water heating (together with hot water boiler)
- 2 blade fixed propeller optimized for engine ratio [16x13x2]

Technical Data

Engine designation	D1-30
Crankshaft power, kW (hp)	20 (27)
Propeller shaft power, kW (hp)	19 (26)
Engine speed, rpm	2800-3200
Displacement, l (in ³)	1.13 (69)
Number of cylinders	3
Bore/stroke, mm (in.)	77/81 (3.03/3.19)
Compression ratio	23.5:1
Dry weight with reverse gear MS15A/MS15L, kg (lb)	140/140 (309/309)
Dry weight with saildrive 130S, kg (lb)	158 (348)
Emission compliance	BSO, EU RCD Stage II, US EPA Tier 3
Rating	R5*

Technical data according to ISO 8665. With fuel having an LHV of 42700 kJ/kg and density of 840 g/liter at 15 °C (60 °F). Merchant fuel may differ from this specification which will influence engine power output and fuel consumption.

*RATING 5. For pleasure craft applications, and can be used for high speed planing crafts in commercial applications

- Mechanical throttle, mounted on cockpit side starboard
- Mechanical engine throttle mounted at cockpit side starboard near helmstation
- 150 L fuel tank
- Fuel system
- Roto moulded diesel tank, 210 L with deckfiller and ventilation
- Tank mounted on hull innerliner and bonded to hull for protection
- Integrated read sensor for level indication at screen in 12 V main panel
- Fuel system with fuel pump, special filter and filler- and return line

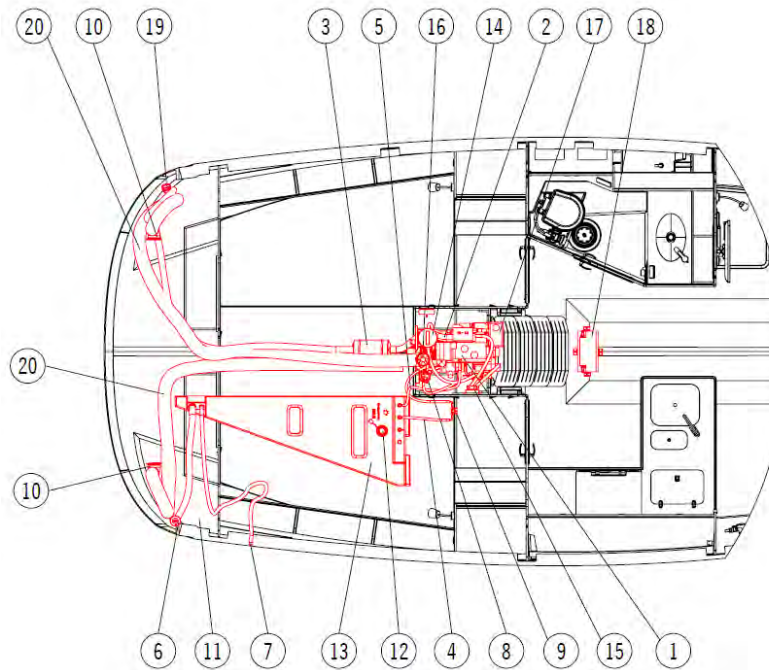
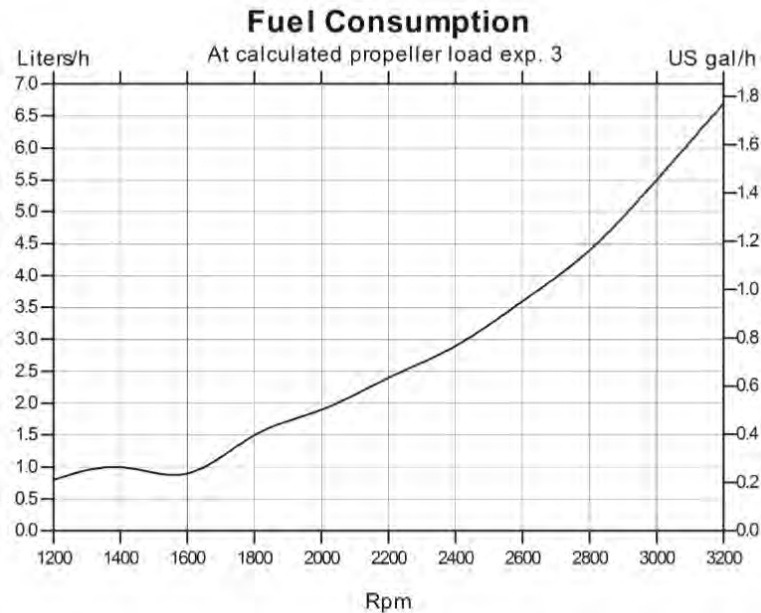

Please see actual pricelist for details Standard and Option

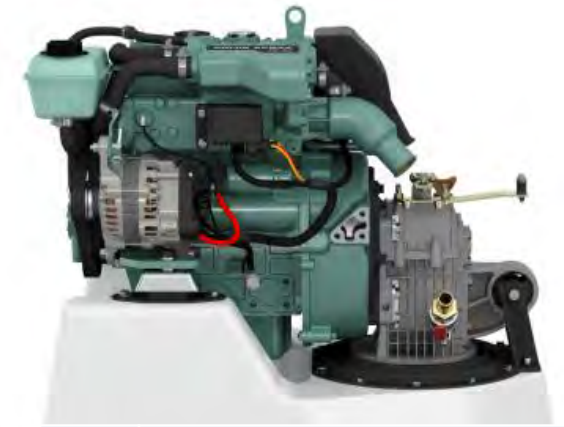

Pos	Description
1	Engine
2	Exhaust system
3	Water collector
4	Fuel pipe
5	Fuel return
6	Deckfiller fuel tank
7	Ventilation fuel tank
8	Fuel filter
9	Fuel valve
10	Ventilation for engine room
11	Engine control (deck)
12	Fuel indicator
13	Fuel tank
14	Seawater filter
15	Vacuum valve engine
16	Ventilator engine room
17	Cooling liquid tank
18	Engine batterie
19	Exhaust
20	Ventilation pipe engine room

4.7 Propulsion

- Folding propeller, 3-blade
 - 3 blade folding propeller optimized for engine ratio
 - Propeller dimensions: 17 x 11 x 3



4.7 Propulsion

- Bow thruster 60 kg, electric incl. operating battery

Thrust at 12/24V* (kg • lbs)	73 • 161
Thrust at 10,5/21V* (kg • lbs)	60 • 132
Typical boat size (ft • m)	29' - 38' • 9 - 12
Tunnel - inner diameter (mm • in)	185 • 7,3"
Propulsion	Single
Power at 10,5/21V* (kW • hp)	3,1 • 4
For DC system (V)	12
Weight (kg • lbs)	16 • 35
Min. battery capacity (CCA**12/24V)	350/175
Control system	Analog



Disclaimer

This Sales Manual is intended for advertisement only and is not part of a contract, warranty or any offer.
We reserve the right to modify or improve our products and to change specifications without notice.
We are not liable for errors and printing mistakes.

Version: **1/2022**

Valid from **1st of August, 2021**

Any previous BAVARIA YACHTS Sales Manual is no longer valid.

Please see actual pricelist for details Standard and Option

